

OKamura

CATÁLOGO DE PRODUCTOS



Finora

OKAMURA



OKAMURA × ITALDESIGN

A statement
of style and identity.

Introducing Finora: dreamed by Italdesign,
a company that excels in mastering the complexity of
automotive design, and engineered by Okamura.
Precision meets soul in graceful symmetries
and clean contours, creating a chair that brings
the beauty of lightness with full features
for any workplace.

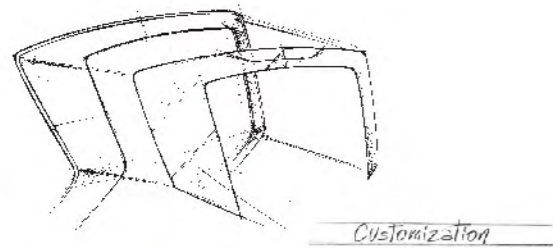
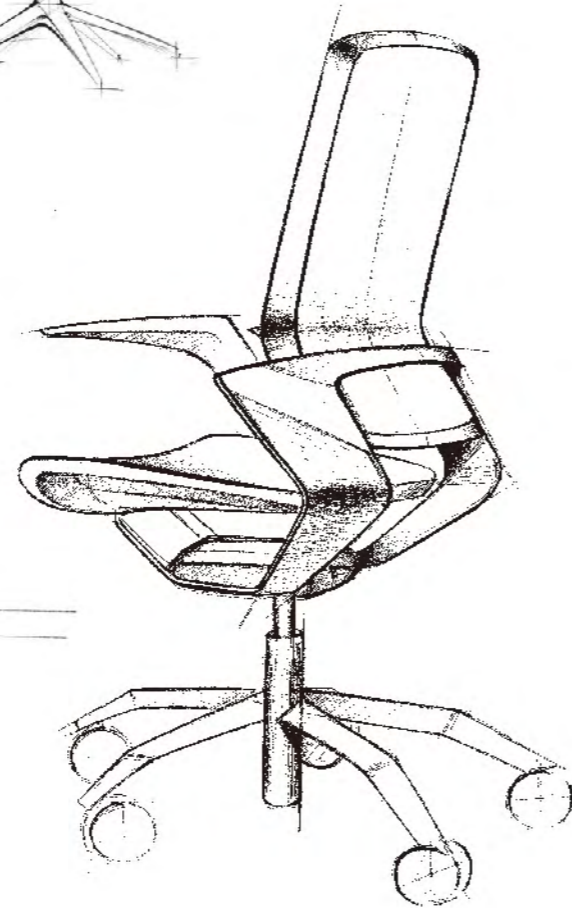
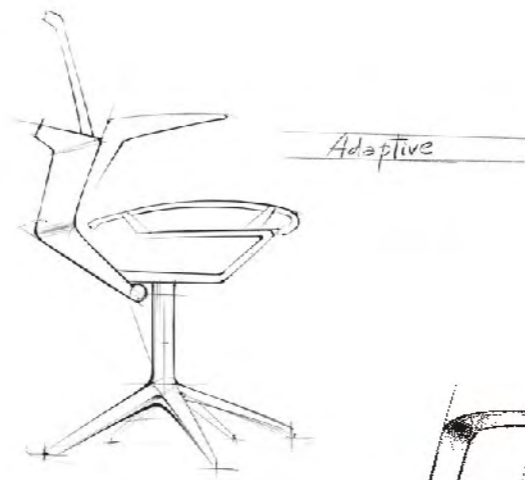

Finora

Luxury meets engineering insight.

Elevate your work in the uncompromised
beauty of lightness.



An uncompromising beauty of lightness.

Every component of Finora is designed to combine style and functionality in one sleek form. The backrest sweeps in a simple curve, gracefully integrating the armrests. Adjustment mechanisms are tucked neatly under the seat.





Maximal impact
with minimal materials.

Thin and light unite to make an understated impact.
The streamlined design is confident in character
and elegantly upscale.

Intelligent engineering.

Highly adjustable, to bring a new level of comfort.
The flexible backrest and 4-D arms adjust to your body,
creating a comfortable seating experience.



Stunning design. Attention to detail.

Inspired by classic automobile styling, commitment to design creates moments of delight throughout.

The decorative panels are available in chrome, black, or white — all with a gloss finish to contrast with the matte mesh finish. Every detail of Finora has been considered to adapt to a multitude of office environments.





Make it yours.

Transform the exceptional into the personal, with finishes that bring radiance and individuality to your Finora chair.

Choose from mesh or standard seat fabric, available in fourteen beautiful colors. The seat can also be upholstered with an upgraded curated selection of fabrics for a sophisticated look.



Now you see it, now you don't.

Unlike other task seating, Finora's backrest and seat are a proprietary matte mesh that is translucent. Visually barely there, but engineered for strength and durability.







www.copytel.com.mx
(624) 143-33-44 Los Cabos (612) 125-23-35 La Paz (624) 191-35-56
Facebook: /Grupo Copytel
Instagram: /grupocopytel_bcs





FUNCTIONS



Flexible Frame

The streamlined backrest flexes with your body for incredible comfort.

Ankle Tilt Reclining

Using the ankle as a pivot point, a tilt mechanism moves in sync with the seat for added support – stimulating healthy variation in posture and relaxation, with uninterrupted comfort.



Seat Height Adjustment

Simply adjust seat height, in a range of 110mm (4 3/8"), with an under-seat finger-operated lever on the right.

Seat Depth Adjustment

Also adjust the seat depth simply, in a range of 50mm (2"), with a light-touch lever under the seat on the left.



Smart Adjustment

Seat adjustment controls are consolidated into a simple cluster under the seat. Controls are easily operated from a natural seated position.



Quick Slide Operation

Reclining tension is adjustable by sliding the lever under the seat on the right.



Lumbar Support

The lumbar support adjusts, in a range of 60mm (2 3/8"), to match the natural S-curve of your spine, reducing the strain on the back for a healthy posture.



Headrest

The large headrest is height adjustable, in a range of 100mm (4"), and angle-adjustable up to 35°, providing optimal neck support for all body types.



Hanger

The height-adjustable hanger can be lowered behind the backrest when not in use.

4-D Adjustable Arms

The adjustable arms easily adjust up and down, pivot inward and outward, slide forward and backward, and in and out.

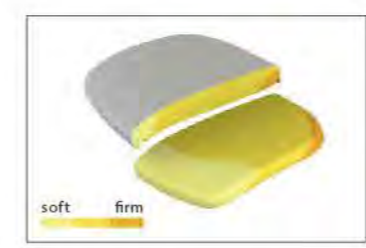

Multiple Density Cushion

Our seat cushion is manufactured by casting urethane foam of three different degrees of firmness together, to create a single cushion. Providing softer support at the front and denser cushioning at the back.



Front Support Cushion for Mesh

The mesh seat is fitted with soft urethane foam at the front of the seat, reducing pressure on the thighs for improved circulation.



SPECIFICATIONS

| Body & Decoration Panel Colors



| Base Colors



| Seat types

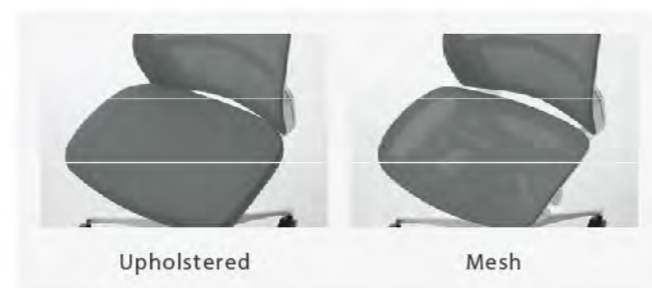

| Armrest Types



| Back Height



| Options



| Backrest: Mesh, Seat: Mesh

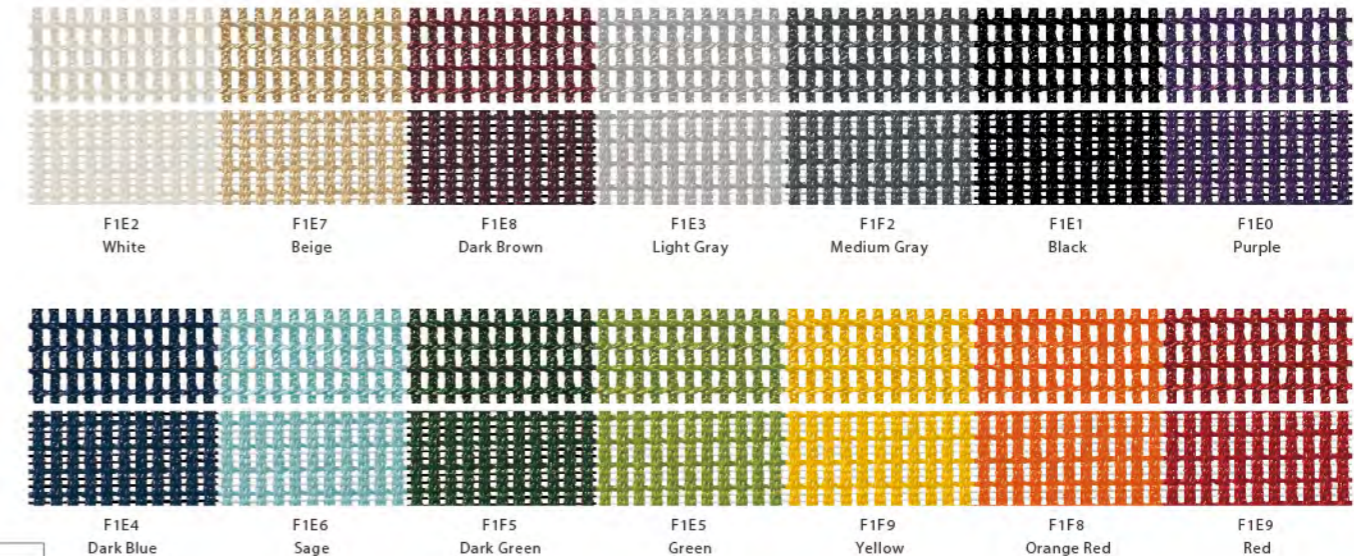

| Backrest: Mesh, Seat: Fabric

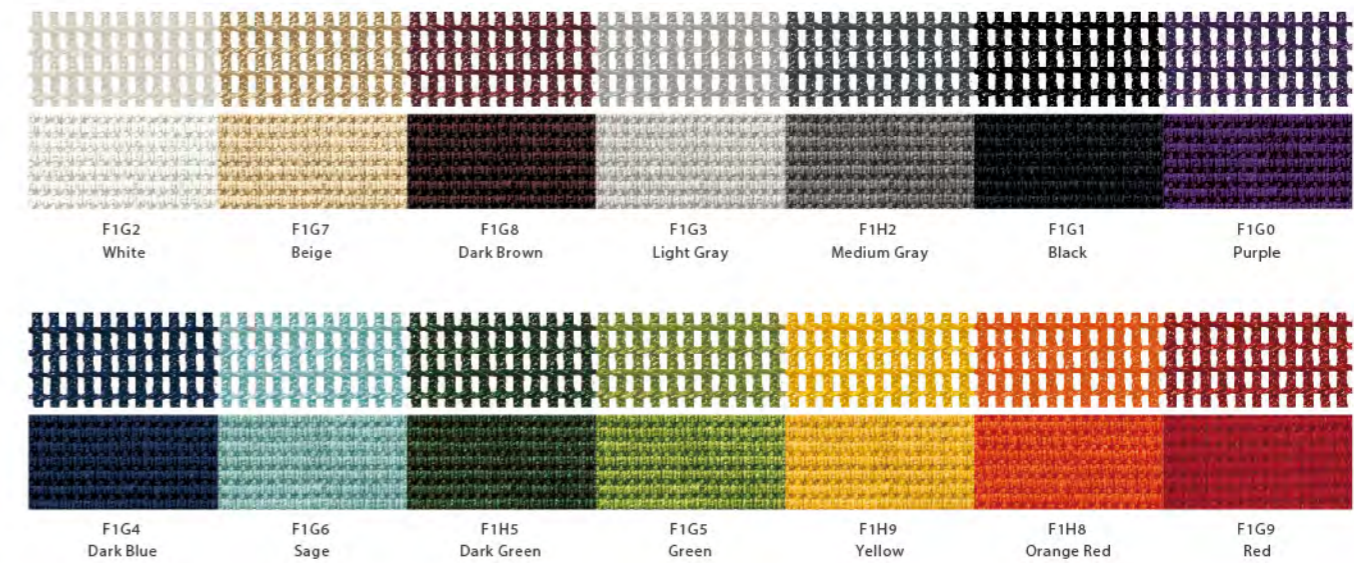

CMF

Color, material, and finish: at Okamura, we believe that the three components that give any chair its final look are three opportunities to inspire creativity and to elevate the seating experience.

Gone are the days of "one style fits all" – think of Finora as a beautifully designed blank canvas to feature many CMFs throughout your offices.



CYNARA

okamura



CYNARA

Weightless beauty. Effortless support.

Experience the impossible lightness and effortless support of Cynara, a task chair that integrates intuitive responsive functionality with a clean-cut, refined aesthetic to complete any work setting.



Cynara's understated elegance will blend harmoniously into all the places people work – from the office, to co-working and home office settings – bringing quiet sophistication and calm productivity into any environment.

By paring back to its essential form and function, Cynara achieves impossible lightness. The frame flexes to provide responsive ergonomic support, eliminating the need for a complex mechanism. The result is simple, functional, light-scale beauty.

Cynara's lighter weight contributes to lower CO₂ emissions through production and logistics, offering a more responsible choice for the planet.

Designer: Andreas Krob × Engineer: Joachim Brüske



Meet the design team

Cynara is the result of a three-year partnership between the Okamura team, Andreas Krob of Swiss design agency b4K and Joachim Brüske. A product and industrial designer, Krob is renowned for attention to detail, workmanship and a holistic approach to design. Brüske's meticulous engineering has ensured that the functionality of Cynara is simpler and more effective than ever. With their combined seating expertise, the pair have created a chair that offers superior lightness.

Inspiration

Cynara was inspired in form and function by the yumi – a Japanese bow, which draws power from its arc form. Similarly, Cynara draws on the strength and flexibility of its gently curved frame, a responsive structure that flexes and adapts, cradling the seat, to support movement and provide comfort.



3.



4.

- 1. Form follows function**
The soft angular lines of Cynara's frame functionally provide flexion that supports the healthy, natural S-curve of the spine in motion.
- 2. Quality workmanship**
The frame and mesh on the seat and back are seamlessly integrated to accentuate the chair's simple beauty.
- 3. Subtle sophistication**
Hollow wheel casters enhance the product's sense of lightness and visually connect the chair with its surroundings.
- 4. Meticulous detail**
Two different colored yarns are interwoven to create a sophisticated, textured, translucent mesh.



Characteristics



Smart ankle tilt reclining

Okamura has scrutinized and refined the conventional mechanism and operation system, to enhance natural comfort and relaxation. The result, Smart ankle tilt reclining optimizes recline tension for each user and has achieved the most simple and intuitive operation system possible. By upgrading our proprietary ankle tilt reclining system, we have achieved the ultimate in comfortable seating.

Okamura's Smart Ankle-Tilt Reclining uses the ankle as a pivot point to move the back and seat in sync. We have scrutinized and refined our conventional mechanism to achieve the most simple and intuitive adjustments and deliver the ultimate in comfort. The result optimizes recline tension for each user. This new smart mechanism and Cynara's all-in-one frame, prevent pressure under the thighs, even in recline.



Highly resolved, light-scale solution

Cynara's superior lightness presents multi-faceted advantages in operations, sustainability and aesthetics. [Product weight: 9kg (20lbs)]



Free recline or upright lock

The lever under Cynara's left side invites you to control the back position. Choose upright lock or recline freely, by up to 12 degrees.



Height adjustment

Adjust the seat height by up to 110mm (4 5/16") to achieve the perfect fit, via the easy-to-reach lever under Cynara's right side.



Specifications

Body & Base Colors

Standard Color



Caster Types



Mesh Colors

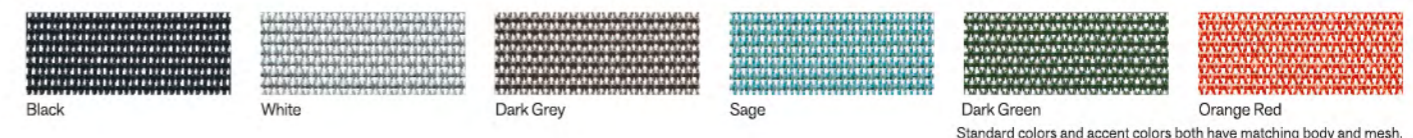

Accent Color



Armrest Types



Ecology

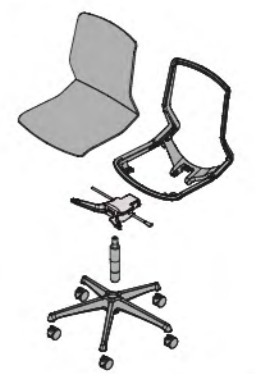

Okamura sought to create the lightest possible task chair for the twin benefits of reduced CO² emissions and easy handling. When compared with our standard products, Cynara's 50% reduction in weight translates to an impressive 35% reduction in CO² emissions. Cynara successfully combines beauty, ergonomics and sustainability.

Standard colors and accent colors both have matching body and mesh.

Contessa II

seconda
OKAMURA



A true icon lasts. A true icon evolves.

Since 2002, Contessa has set the standard for seating in office spaces around the world. Now, she is reborn as Contessa Seconda.

Contessa Seconda unites the flowing, organic lines and charm of the original with new engineering and functionality. With more color options for the mesh, fabric, and frame. All to meet the demands of the modern work style.

Contessa Seconda is the evolution of an icon — for the workplace of today, and of tomorrow.

Contessa II seconda







A classic, re-imagined.

Four design principles led the upgrade of this iconic chair:

- 1 Engineered for modern offices**
Built to new strength standards, to meet the requirements of today's task chairs.
- 2 Personal comfort**
Okamura leverages its world-renowned technology for comfort and a superb fit to every body.
- 3 New colors and frame options**
Available in an exciting, industry-leading yet refined palette. A white frame option is also newly available.
- 4 Extended line-up for any space**
The full range of Contessa Seconda caters to conference rooms, meeting areas, touch-downs, and task applications.



The perfect fit.

Contessa Seconda is engineered for any body type, delivering world-class strength to all.

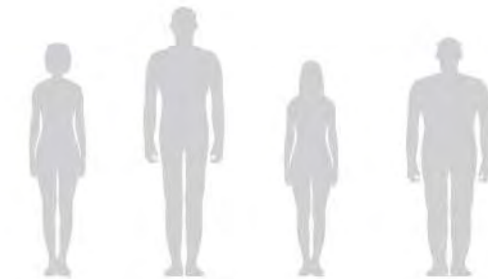



Luxury evolved. So has Contessa.



The backrest frame has been streamlined to create a slimmer aesthetic, with an increased flexibility that gently follows the natural movement of the body — without any sacrifice of support.



For added stability, the mesh seat frame is now constructed in a one-piece ring structure with soft edges, ensuring improved weight-distribution and comfort.

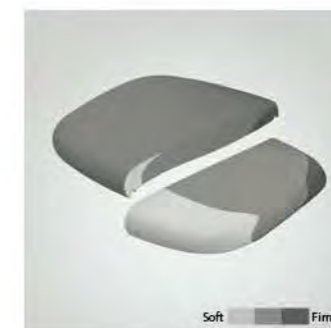

Okamura's unique Multiple Density Cushion utilizes three types of urethane foam, of varying firmness layered together, to promote healthy sitting. The cushion provides softer support at the front of the seat, reducing pressure on the thighs for improved circulation; denser cushioning at the back firmly supports the hips for stability and improved posture.

Soft Firm



Smart operation, now in 4D.



Smart Operation
Adjust your entire seating experience with a touch of your fingertips. Lock and unlock the backrest, alternating between a free recline and one of five pre-set tension gradations — all using a lever in the left armrest. Adjust the chair height, within a range of 435 to 545 mm, using a lever in the right armrest.



Adjustable Arms
Adjustable arms can be adjusted in four dimensions: height, depth, width, and angle — enabling the most comfortable elbow support for the various tasks at hand.



Mesh, made even more beautiful.

For years, Okamura has made beautiful, tactile mesh for its seating by intertwining luxe-touch and stretchable, strong threads. Contessa Seconda features an upgraded mesh, that is more permeable and lighter in weight for the backrest, and a new luxe-touch mesh for the seat. Modern colors and a new white-frame option make it even easier to coordinate with a wide variety of spaces.

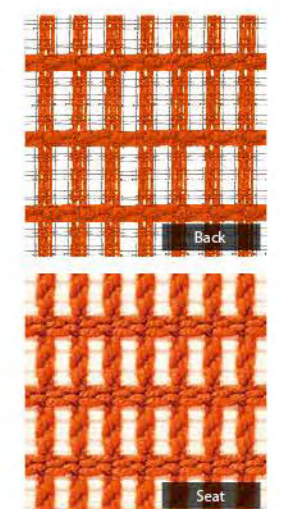

More options for today's workspaces.



Contessa Seconda elevates the look and feel of any office environment.



An ergonomic task chair that harmonizes with any workspace.



Contessa II x traverse

Variations

Chair types



Color options for frame and body

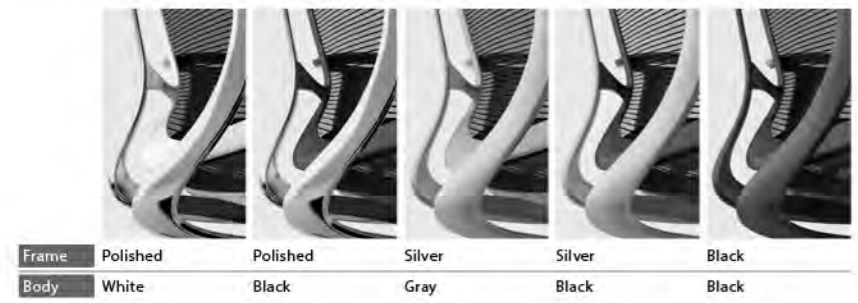

Armrest types



Seat types



Armpad types



Mesh & Fabric Colors



Functions

Ankle-Tilt Reclining



An ankle-tilt mechanism enables anyone to find his or her most comfortable reclining position. Using the ankle as a pivot point, this mechanism moves in sync with the seat, for greater support — stimulating variation in posture and relaxation, with uninterrupted comfort.

Smart Operation Mechanism

A custom seating experience, at your fingertips.



Options

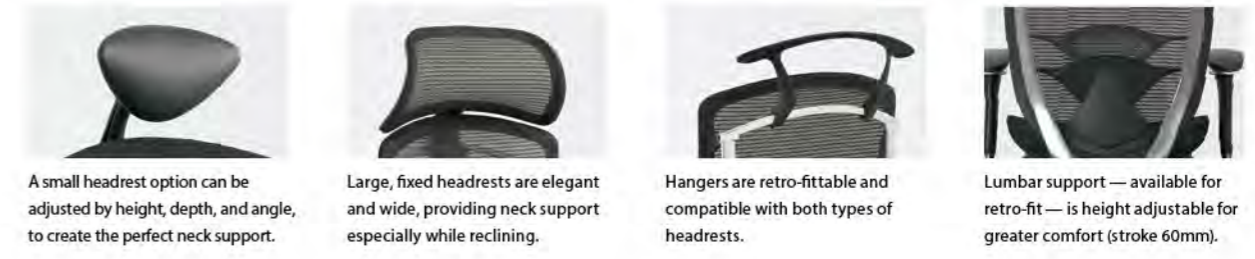

Dimensions

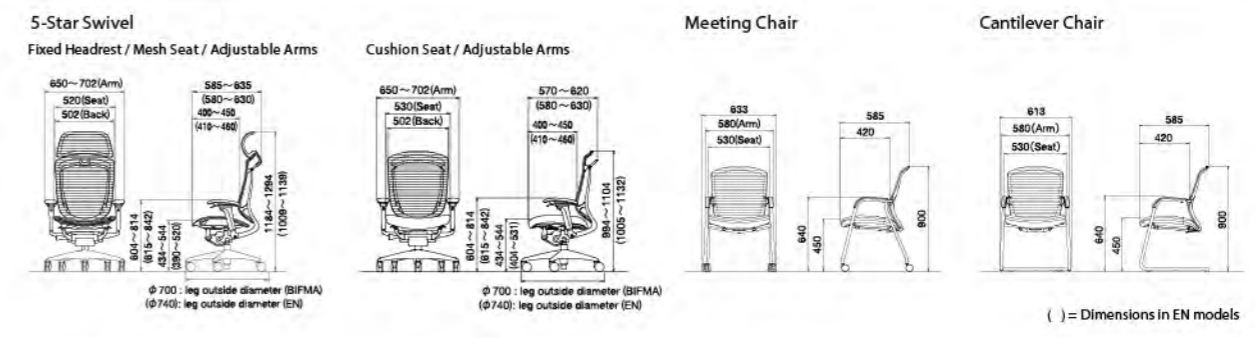

Sabrina

OKAMURA



Sabrina

Sabrina. Beauty at work.

Sabrina embodies Okamura's philosophy of design, in which beauty and comfort work together to create lasting trust and confidence. The iconic flexible ring structure creates a striking and streamlined visual. The chair supports your posture, flexing to follow every movement. Lean back, stretch, reach — Sabrina accommodates every movement in a way that feels natural. So you can work effortlessly.

Standard

Smart Operation



Sabrina Standard

Setting the standard for comfort. Sabrina Standard's Synchro reclining mechanism moves in sync with you - when you move in the chair, the backrest and seat move backwards or forwards accordingly - supporting to your body at all times.



Sabrina Smart Operation

An upgrade of the standard. Intuitive armrest controls and an Ankle-Tilt Reclining mechanism which naturally distributes body weight make for all-day wellbeing and comfort.

The Iconic Sabrina Ring Structure

Superlative technology, in a shapely appearance. The inner frame embraces you as you sit, while the outer frames fan out, allowing for your body to bend effortlessly to the left and right. As you move, air flows through the strong, flexible mesh, adding a sense of lightness and comfort.



Designed by ITALDESIGN

Sabrina is another award-winning collaboration between Okamura and ITALDESIGN. The curved, organic form applies ergonomics to technology, to create harmony between the human body and the working environment.



Profile:

The Industrial Design Division of ITALDESIGN, headquartered in Moncalieri, Torino - Italy, was established in 1981 and today is one of the most renowned and leading organizations in the industrial design field on a worldwide level.

Standard



FUNCTIONS



Reclining Tension Adjustment

A dial under the seat adjusts the reclining tension.



Seat Height Adjustment

A lever under the seat adjusts seat height in the range of 400 mm-530mm.



Reclining Lock and Tilt Adjustment

A dial under the seat locks and unlocks the reclining function and allows you to enter forward-tilt position that comes in useful when working at computers or writing.



Synchro Reclining

The chair's backrest and seat can be synchronously reclined at maximum angles of 23 degrees backward and 10 degrees forward.

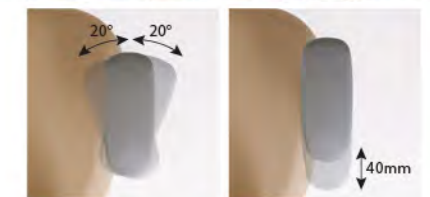

Adjustable Arms

Arms can be adjusted in three dimensions: height, depth, and angle — enabling the most comfortable elbow support for a variety of tasks.



Seat Depth Adjustment

A lever under the seat adjusts seat depth within a range of 50mm.



Multiple Density Cushion

The cushion utilizes three types of urethane foam, of varying firmness layered together, to promote healthy sitting. Softer support is at the front of the seat, reducing pressure on the thighs for improved circulation; denser cushioning at the back firmly supports the hips for stability and improved posture.

Smart Operation

FUNCTIONS

Smart Operation

Adjust your entire seating experience with a touch of your fingertips.

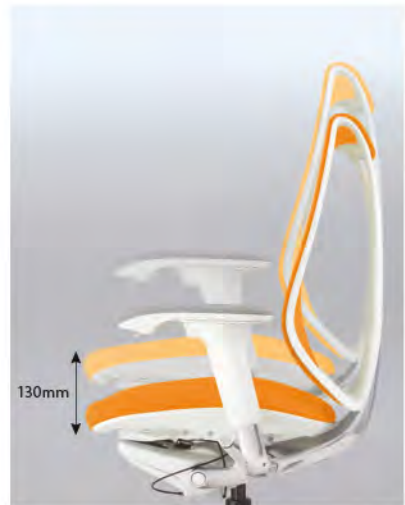

Seat Height Adjustment

A lever in the right armrest adjusts chair height, within a range of 390 to 520 mm.



Reclining Tension Adjustment

A lever in the left armrest locks and unlocks the backrest.



Seat Depth Adjustment

A lever under the seat adjusts seat depth within a range of 50mm.

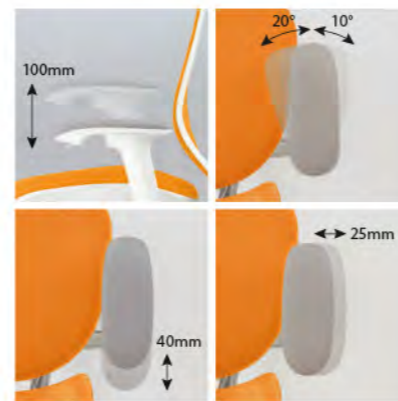

Adjustable Arms

Arms can be adjusted in four dimensions: height, depth, width, and angle — enabling the most comfortable elbow support for a variety of tasks.



Quick Slide Operation

A lever under the seat adjusts reclining tension.

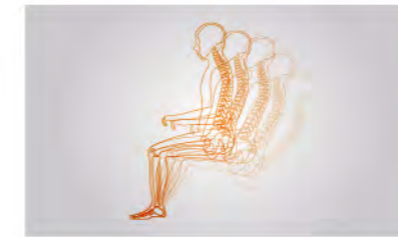

Ankle-Tilt Reclining

The ankle-tilt mechanism enables anyone to find his or her most comfortable reclining position. Using the ankle as a pivot point, this mechanism moves in sync with the user, for greater support — stimulating variation in posture and relaxation, with uninterrupted comfort.



Multiple Density Cushion

The cushion utilizes three types of urethane foam, of varying firmness layered together, to promote healthy sitting. Softer support is at the front of the seat, reducing pressure on the thighs for improved circulation; denser cushioning at the back firmly supports the hips for stability and improved posture.





Sabrina
Standard | Office Scene



Sabrina
Standard Meeting Scene





Sabrina | Office Scene
Smart Operation

Sabrina | Executive Scene
Smart Operation

SPECIFICATIONS

Standard



Retro-fit Options



Headrest Lumbar Support Hanger



Adjustable Arms Fixed Arms

Smart Operation



Retro-fit Options



Headrest Lumbar Support Hanger

Color Variations



Dimensions

	Standard	Smart Operation
High Back	<p>with Adjustable Armrest with Fixed Armrest with Adjustable Armrest / High Chair</p>	<p>with Adjustable Armrest</p>
Extra High Back	<p>with Adjustable Armrest with Hanger and Lumbar Support with Fixed Armrest with Hanger and Lumbar Support</p>	<p>with Adjustable Armrest with Adjustable Armrest with Hanger and Lumbar Support</p>

All dimensions shown are for BIFMA models.

Awards & Certification

Standard



Smart Operation



Ecology

Okamura uses environmentally friendly materials and modular designed parts. Major resin parts are labeled for easier recycling and disposal.

- Designed for disassembly and recycling
- PET recycled fabric
- Designed for longevity and durability
- Positive use of recycled resin



Sylphy

okamura



An office chair
that's got your back.

Your body shape is unique. When it comes to finding an office chair that's high performance and high comfort, it's personal. That's why Okamura developed the Sylphy chair with an exclusive simple-to-use Body Curve Adjustment. After all, it's your chair, shouldn't it fit you perfectly?



Sylphy



reddot award 2015
winner



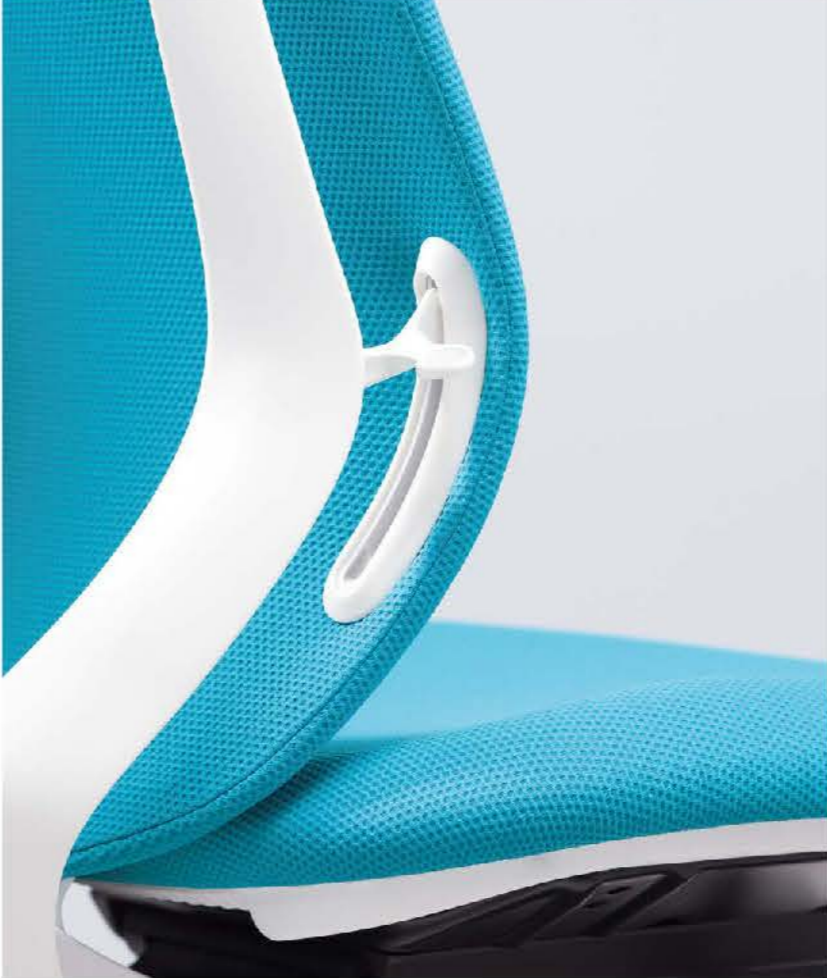

An office chair should fit you (not the other way around).



Measurement of abdominal circumferences of people when seated.

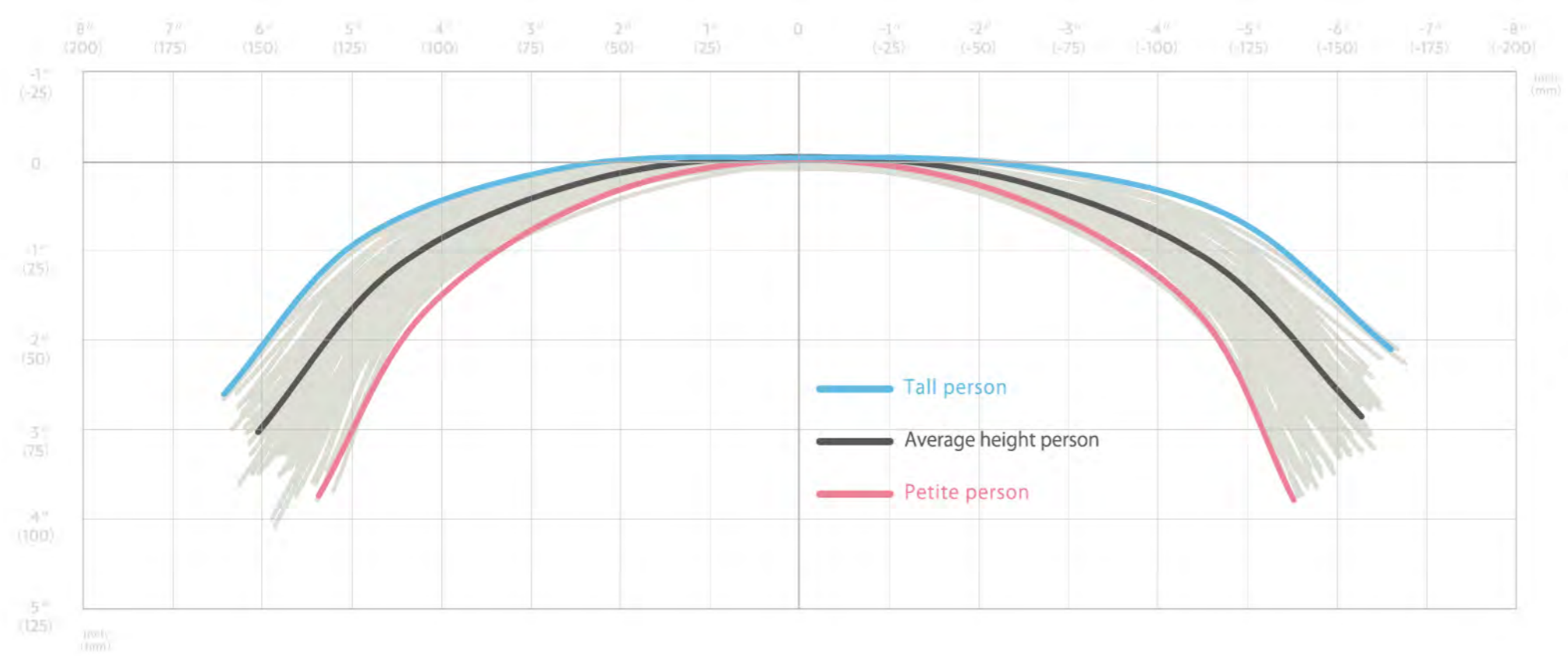

During product development, we measured the waist circumference of a hundred people, closely observing the differences we found. The answer is our exclusive Body Curve Adjustment. It's easy to experience a superb fit by simply flipping the levers on the backrest.

Designed for every body.



Easy to personalize

With the **Body Curve Adjustment**, it takes just seconds to customize the fit of the backrest. Pushing down the levers on the sides of the backrest broadens the curve for a more relaxed fit, ideal for those with a larger stature. Pulling the levers up forms a narrower curve for a firmer fit, ideal for those of a smaller build.

Designed to flex

Sylphy's backrest frame was designed to bend slightly with the motion of your body. This is achieved with a unique **Double-Structured frame** joined together by minimal touchpoints. The supple inner frame, which comes in direct contact with your back, supports the mesh and upholstery setting, while the hard outer frame provides structural durability and strength, to give you a more comfortable, natural posture.

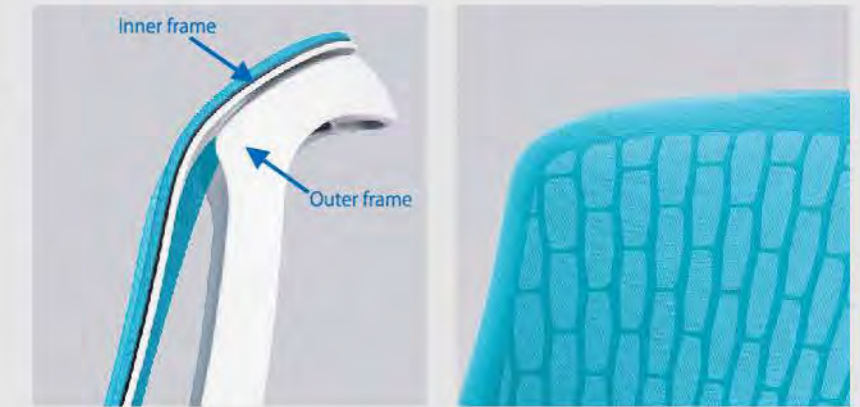

*Structure is specific to the upholstered version only.



Designed to curve

The form of the chair is designed to wrap around your body to create a comfortable seating experience with just the right amount of curve. Okamura's **Multi-Density Cushion** provides softer support at the front of the seat, reducing pressure on the thighs for improved circulation. Denser cushioning at the back firmly supports the hips for stability and improved posture.



Small Stature



Narrow curve fits the body for small builds.

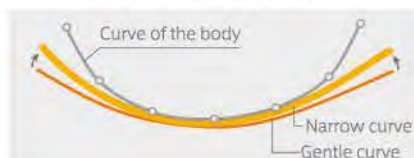

Large Stature



Broad curve fits the body for large builds.

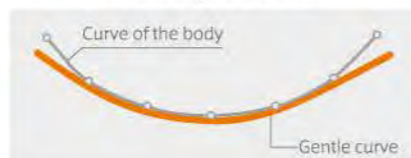

Designed to flow

The **Synchro-Tilt mechanism** moves the backrest and seat in sync for increased comfort and support. With both standard reclining and forward tilt functions you can choose from free-flow recline, or locked positions to accommodate various needs and work styles. The **Forward-Tilt function** allows the seat to tilt forward 10 degrees, so Sylphy can support you even through long periods of intensive computer work, by keeping the pelvis in a neutralized position.

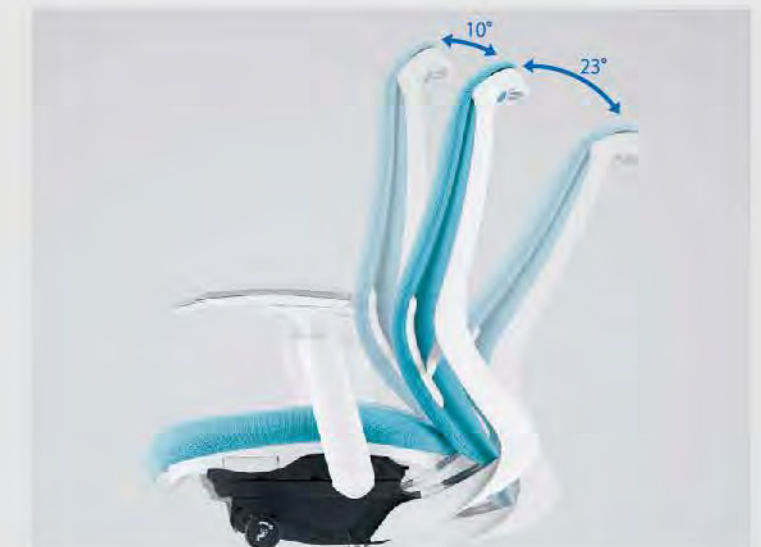

Sit in comfort.



Find the model that fits your needs.





Beautiful for any work environment.

Line Up

Backrest Types



Mesh

Upholstered

Backrest Options



High Back with Headrest

High Back

Low Back

Color Options for Body and Leg



White / Polished



Black / Polished



Black / Black Plastic

Armrest Types



3D Adjustable Armrest

Fixed Armrest

Without Armrest

Options



Adjustable Hanger

Fixed Headrest

Lumbar Support
(For Mesh Type only)

Functions

Seat Height



Adjust the chair height, within a range of 5 1/8" (130mm), by pulling the lever under the seat on the right.

Seat Depth



Adjust the seat depth within a range of 2" (50mm) by operating the lever on the left-hand side of the seat.

3D Adjustable Armrest



The arms of the chair can be adjusted in three dimensions. By pressing the button under the arm pad, the arm height can be adjusted in a range of 4" (100mm). The depth and angle of arm pads can be adjusted within a range of 2" (50mm), at an angle of up to 20° respectively.

Reclining Tension



The dial under the seat on the right side adjusts the reclining tension.

Recline & Lock

The synchro-tilt mechanism moves the backrest and seat simultaneously. A dial under the seat allows the backrest be set to move freely or be locked in one of the four positions:

1. Forward-tilt (10 degrees)
2. Upright
3. Backward-recline position
4. Deepest backward-recline position (23 degrees)



Benefits of Forward-tilt Function



When hunching forward for a prolonged time period, the body experiences undesirable pressure on the abdomen and the lower back. Forward-tilt function helps to reduce the stress on your body by maintaining the natural s-curve of the spine for better posture.

Color Options

Upholstered Backrest

Plain

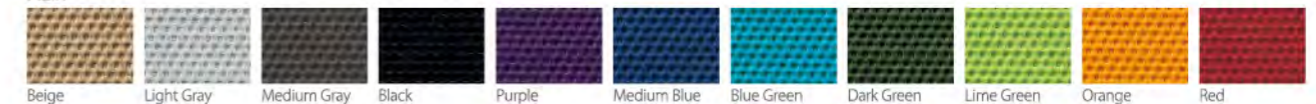

Interlock



Mesh Backrest

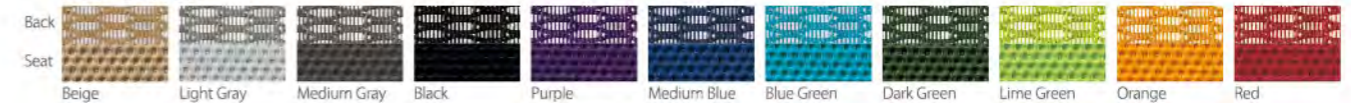

Luce

OKAMURA



Comfort.
Whenever,
Whoever,
Wherever.



It is perfect for lively brainstorming sessions or for quiet concentration on your own.

A good fit no matter whom, no matter where and no matter when.

Introducing the LUCE chair.

In our ever evolving office environment we are moving towards more and more shared work stations and collaborative project.

This necessitates comfortable office seating with the ability to be used in multiple places by a variety of people. Luce supports this dynamic adaptable work environment and encourages each individual to shine.

The adaptable office. What a concept.

Luce





Flexible design transforms the workflow.

A chair that adapts to the task at hand.

Be it working on a project as a group or checking paperwork on your own.

Perfect for the fast pace, on the move office.



Opening up a space to movement makes for more active communication.

Pull together for a large meeting or break apart to a quiet area for more confidential discussions.

Find a place to spread out your materials and get organized.

A perfect fit for countless situations.



Pop over in comfort for a short meeting.

Meeting spaces between workstations can be configured at ease with base panels. The Luce is engineered with a special brand of comfort for even the shortest of meetings.



Make the space you use most, the most pleasant.

Enjoy comfort with this flexible seating and firm support, even in meeting rooms with the highest traffic. Create an atmosphere conducive to brisk and easy communication.



Ideas are born when you are on the move.

Even greater versatility when used together with tables on castors. Linking your laptop up to a projector for a presentation or brainstorming on a whiteboard.



A light and easy feeling in a relaxing environment.

Provide comfortable seating in conference rooms for important meetings or for conversing with key clients.

Smart Relaxation Seat



The forward tilted seat gently greets the body and supports the seating to ease the weight load to the thighs and the lower back.

The forward tilted seat flexibly adjusts the angle of seating at the maximum of 15 degrees that provides the proper seating position from an ergonomic aspect.

The backrest reclines at maximum of 15 degrees with synchro-tilt function achieving a comfort.

Robot Leg Technology

The Robot Leg was developed through research into the mechanics of human bones and muscles that can "jump" and "land" on the ground just like us.

OKI Electric Industry's expertise accumulated during the Robot Leg development combined with OKAMURA's expertise in chair development gave birth to a totally new chair "Luce".



Gradated Supportive Mesh



The gradation in the mesh fabric is a cutting-edge technology which has made it possible to change the mesh density to create support where needed.

The area around the lumbar is highly dense for firm support, while the upper back area is less dense to provide a soft and comfortable fit. The gradated design is appealing in both aesthetic and functionality.

Mesh Density	Cushioning Effect
Low	Soft
Mid	Mid
High	Firm



Located in the suburbs of Torino Italy, GiugiaroDesign, the Industrial Design Business Unit of Italdesign Giugiaro, was founded in 1981 and today ranks among the leading organizations in the field of industrial design worldwide. GiugiaroDesign has received acclamation for its stylish and user-centric functional designs of various products, ranging from furniture and home appliances, to watches and cameras.

Specifications



Color Variation

	FGP1	FGP2	FGP3	FGP4	FGP5	FGP6	FGP7	FGP8	FGP9
BACK									
SEAT									
Set Code	Black FGR1	White FGR2	Medium Blue FGR3	Aqua Blue FGR4	Lime Green FGR5	Mango Yellow FGR6	Beige FGR7	Dark Brown FGR8	Red FGR9

Adjustment



Seat Height Adjustment
 The seat height can be adjusted up and down (100mm with flexible levels) using the lever on the right hand side.

Ecology

- Designed for Recycling**
 Designed for ease in separate materials for recycling.
- Recycled PET Cloth**
 Thanks to advanced recycling technology, recycled PET cloth with polyester fibres from plastic bottles and fibres is used in manufacturing of the chair.
- Designed for Longevity**
 The back and seat cushions can be replaced separately, making for easy maintenance and a long service life.
- Ample Use of Recycled Resins**
 Recycled resins are amply utilized to help make effective use of existing resources.



Visconte

OKAMURA



Visconte

The grid pattern of “Visconte” has been inspired by the Japanese architectural form “Kohshi.” The traditional wisdom realized in this grid structure helps block the light gently and divide the space quietly. In Visconte, this grid patterned backrest offers a surprisingly soft sense of coziness. Once you sit down, the comfort and performance of this new seating will be surely recognized.

FLEXIBLE GRID BACK

The grid back fits the user's physique perfectly, created from the advanced technologies and ergonomic engineering of Okamura.

The unique backrest of Visconte makes full use of our "Finite Element Analysis Technology." This innovative design has given birth dedicatedly to provide ergonomic comfort by fully utilizing the features of its materials and computing physical load balance. By controlling the shape of the slots, the Flexible Grid Back holds where you need support, while stretches where you need softness.



SOFT & COMFORT

The upper portion of backrests bear the highest load. This portion flexes widely when pressure is given. It is designed to create softness, comfort and pressure distribution to the back.



SUPPORT

The support to the lumbar is important for ideal posture. The grid back of Visconte provides elastic, but stable support to this part of peoples back.



okamura

FULL ERGONOMIC SUPPORT



“Visconte” satisfies with all the required features for ergonomic comfort.

Office seating is the only furniture that comes in contact with the human body directly and widely during long working periods. Working quality directly relates to comfort. Okamura believes ergonomic designs guarantee maximum physical and mental well-being. Visconte makes the most of our long year research in ergonomic engineering.

RECLINING MECHANISM

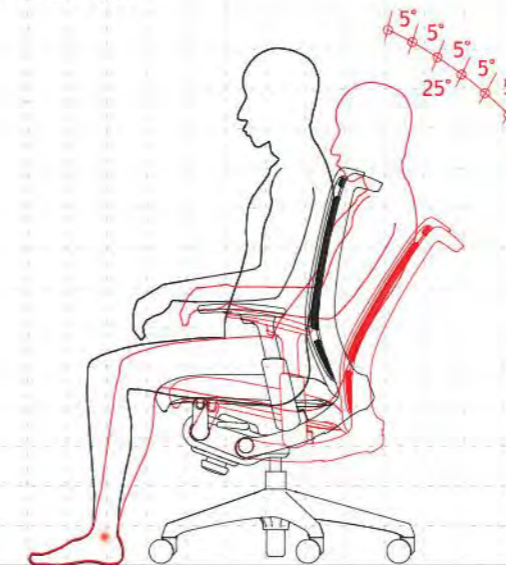

The original “ankle-tilt reclining” system interlocks the backrest and seat with the ankle centrally located in the movement. This mechanism developed by the joint of engineering excellence and ergonomic research, assures natural posture for hours of comfort. Backrest can be locked in several positions for user application. Reclining tension control is provided at the front side of the chair.

ADJUSTABLE ARMREST

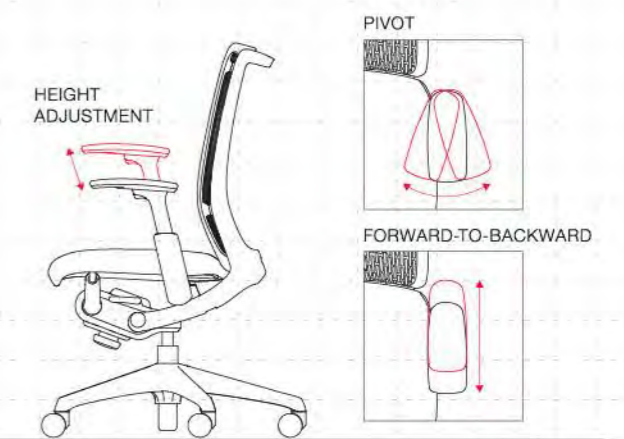

Armrest moves vertical, forward-to-backward, and pivots. They will protect the worker as much as possible from fatigue during long periods of computer work.

SEAT DEPTH ADJUSTMENT

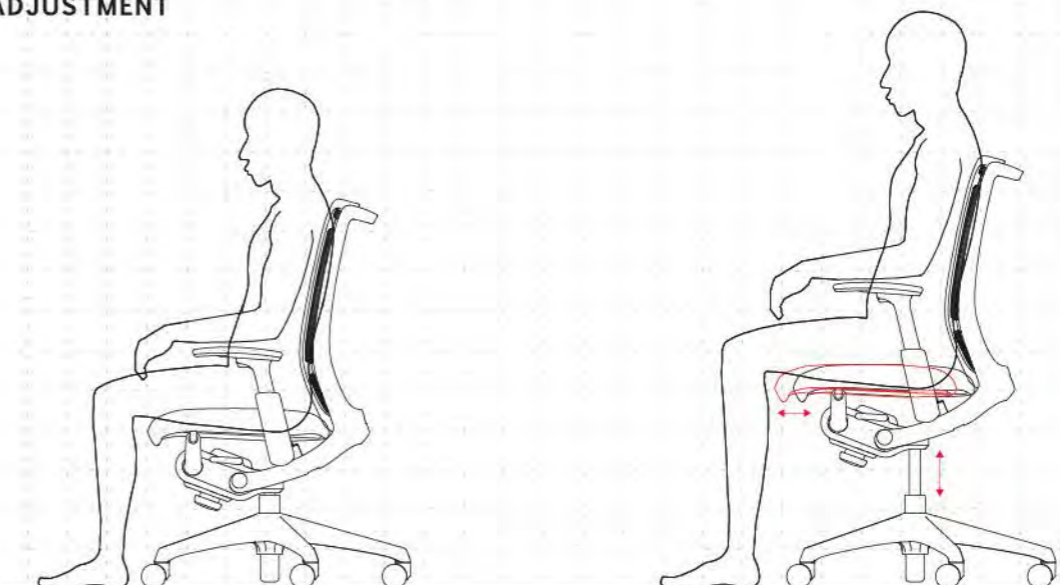

The seat depth can be adjusted forward-to-backward 50mm, easily by one-hand. This intelligent feature helps adjusting to the most appropriate sizing for wide range of people.

3-TYPE BACKREST SELECTION

Three types of backrest designs are available to meet every expected situation. They are environmentally friendly in design, with easily attachable and detachable functions.

CUSHION

PLAIN

MESH



The basic design fits any conceivable workplaces.



The user may surely feel the softness of the backrest material.



A single layer of mesh changes both the feeling and design.

MULTIPLE VARIATIONS

Visconte is an office seating series that comfortably meets the needs of more diversified workplace environments.

In order to meet the broad range of needs of individuals, workplaces and business scenes, Visconte offers a variety of selectable specifications.



SELECTION FLOW

STEP 1

BACKREST DESIGN



PLAIN

CUSHION

MESH

STEP 2

SHELL COLOR



BLACK

GRAY

STEP 3

BACKREST HEIGHT



LOW BACK

HIGH BACK

STEP 4

SEAT

SEAT DEPTH ADJUSTMENT

SEAT COLOR



FIXED SEAT / DEPTH ADJUSTABLE SEAT

RED

MEDIUM BLUE

PISTACHIO GREEN

STEP 5

ARMREST



ARMLESS

FIXED ARMREST

ADJUSTABLE ARMREST

STEP 6

OPTIONS



ADJUSTABLE LUMBAR SUPPORT

An optional height-adjustable lumbar support is available for those who need additional support.

COAT HANGER

An optional coat hanger is attachable to the seat back.

FREE RECLINING TYPE

A reclining mechanism without position lock is available for specific scenes.

COLOR VARIATIONS

Visconte provides a broad selection of colors. To brighten your beginning of the day, warm up your afternoon, vivid the long meeting and cool down before leaving the day.



BACKREST	PLAIN	PLAIN	CUSHION	CUSHION	MESH	MESH	MESH	PLAIN	CUSHION	CUSHION	PLAIN	PLAIN
BODY	BLACK	GRAY	BLACK	GRAY	BLACK	BLACK	BLACK	GRAY	BLACK	GRAY	BLACK	GRAY
SEAT	ORANGE	LIGHT GRAY	MEDIUM BLUE	PISTACHIO GREEN	BLACK	BLACK	MEDIUM BLUE	PISTACHIO GREEN	RED	ORANGE	LIGHT GRAY	BLACK

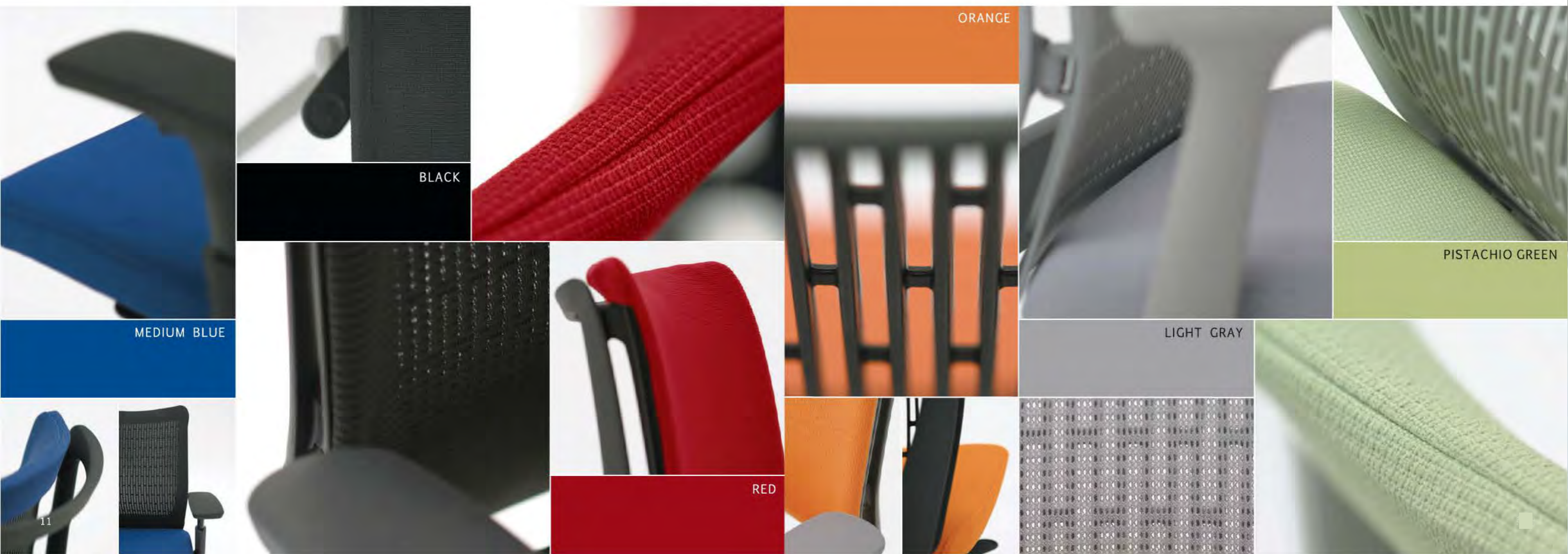



SUSTAINABLY DESIGNED

Visconte, for the greenest environmental workplaces.

SUSTAINABLE PRODUCT LIFE CYCLE

Coexistence of nature and human society was ordinary in traditional Japanese lifestyle. Therefore, it was natural for Okamura to achieve ISO14001 in 1997, pioneering the global industry. Now, all processes of our activities, realizing the life cycle of each products that we provide, are environmentally managed to reduce environmental load in each moments.

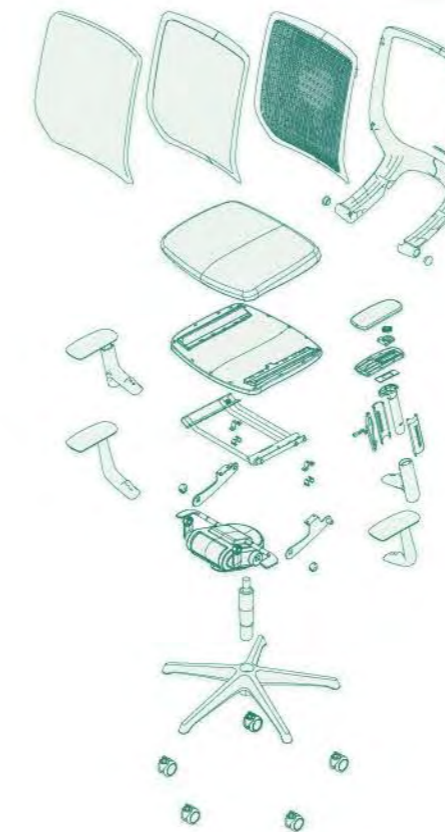
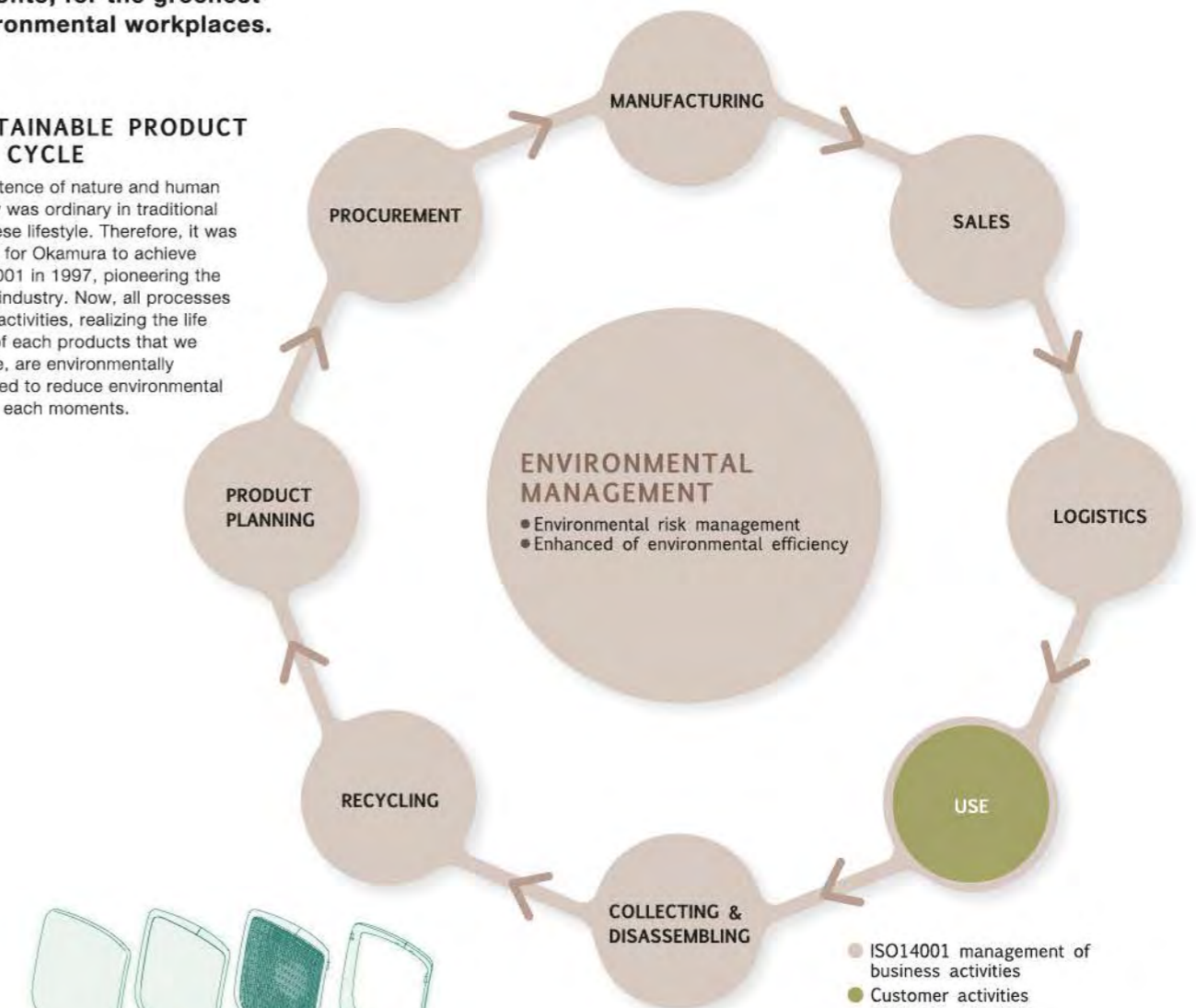

DESIGNED TO LIVE LONG, AND RECYCLED

Many components of Visconte can be attached, detached or replaced after arriving to users hand. There is no need to have overmuch features before needing those, nor to replace the whole chair before the end of its life. Instead of going to the grave, almost all of Visconte can be disassembled to single materials and send to recycling to rebirth.



RUNO

okamura



Moving Runa

Work, people and products on the move



Simplistic design that embodies the functional needs of a versatile office environment.

“Runa” offers a comprehensive seating collection with a wide variety of colors and finishes.

When you need freedom to think creatively and want those big ideas,

“Runa” gives you the freedom and support to succeed.



Run a **seminar**

Breeze through your seminar in comfort.



www.copytel.com.mx
(624) 143-33-44 Los Cabos (612) 125-23-35 La Paz

(624) 191-35-56

[/Grupo Copytel](https://www.facebook.com/GrupoCopytel)
[/grupocopytel_bcs](https://www.instagram.com/grupocopytel_bcs)

Run a **meeting**

To give you that extra stamina needed during a long meeting.





Run a **brainstorm**

Open up your mind with an open space.



Run a **groupwork**

Feel free to speak your mind.

Variations

Basic
562W x 560D x 457SH-837H
(22 1/8"W x 22 1/8"D x 18"SH-33"H)

with Armrest
565W x 560D x 457SH-837H
(22 1/4"W x 22 1/8"D x 18"SH-33"H)

with A3 Tablet
668W x 700D x 457SH-837H
(26 3/8"W x 27 5/8"D x 18"SH-33"H)

with Storage
562W x 560D x 457SH-837H
(22 1/8"W x 22 1/8"D x 18"SH-33"H)

with Armrest & Storage
565W x 560D x 457SH-837H
(22 1/4"W x 22 1/8"D x 18"SH-33"H)

with A3 Tablet & Storage
668W x 700D x 457SH-837H
(26 3/8"W x 27 5/8"D x 18"SH-33"H)

* mm (inch)

Swivel Chair

Basic
475W x 560D x 425-517SH-805-897H
(18 3/4"W x 22 1/8"D x 16 3/4-20 3/8"SH-31 3/4-35 3/8"H)

with Armrest
565W x 560D x 425-517SH-805-897H
(22 1/4"W x 22 1/8"D x 16 3/4-20 3/8"SH-31 3/4-35 3/8"H)

with A4 Tablet
550W x 640D x 425-517SH-805-897H
(21 3/4"W x 25 1/4"D x 16 3/4-20 3/8"SH-31 3/4-35 3/8"H)

with Armrest & A4 Tablet
595W x 640D x 425-517SH-805-897H
(23 1/2"W x 25 1/4"D x 16 3/4-20 3/8"SH-31 3/4-35 3/8"H)

Basic
475W x 560D x 620-774SH-1000-1154H
(18 3/4"W x 22 1/8"D x 24 3/8-30 1/2"SH-39 3/8-45 3/8"H)

with Armrest
565W x 560D x 620-774SH-1000-1154H
(22 1/4"W x 22 1/8"D x 24 3/8-30 1/2"SH-39 3/8-45 3/8"H)

* mm (inch)

Color

Shell

Sage Lime green Yellow Neo white Gray Neo black

Frame

Silver metallic Neo white Black

Fabric

■ **3D Knit**

Medium gray FSG2 Black FSF1 Medium blue FSF3 Sage FSG7 Lime green FSF5 Yellow FSG9 Red FSF9

■ **Interlock**

Beige FXW2 Dark brown FXW3 Gray FXW1 Dark Gray FXW0 Indigo FXW4 Sage FXW9 Dark green FXW5 Yellow FXW7 Terracotta FXW6 Pale pink FXW8

■ **Synthetic leather**

Neo black PB20 Sage PD31 Lime green PD32 Yellow PD33

Functions

Comfort Back Shell

The shell's flexible slit structure provides firm support to the lower back while allowing comfortable flex for lateral movements and leaning back.



Comfort Cushion

The flexibility of the fabric and the 3D gradation urethane cushion provides superior comfort.



Comfort



The perforated seat cover and spacer fabric allows for greater breathability.



The flip back design reduces pressure points on the backrest.



For padded comfort, specify the optional backrest pad.

Mobility



You can choose from hard casters or soft casters, with or without brakes for durable mobility.



The high tensile steel frame is robust and light.

Compact (Nesting Chair)



Space efficiency is achieved by nesting pitch of 125mm (5 inch).



Nesting pitch is 150mm (6 inch) with foldaway A3 tablet.



Even with armrest, 3 chairs can be used (as shown) with the standard size 1,800mm (70 7/8 inch) folding table.

Safety (Nesting Chair)



The seat flips down slowly, avoiding unwanted noise and the risk of trapping fingers.



Framework support is set back beneath the seat to reduce risk of trapping fingers.

Safety (High Chair)



The foot ring of the high chair allows for greater stability while sitting and when getting on and off.

Sustainability

Developed and manufactured through an ISO14001 managed operation.



INDOOR ADVANTAGE GOLD FURNITURE

Okamura uses environmentally friendly materials and modular designed parts. Additionally, major resin parts are labeled for easier recycling and disposal.

Recycled material used 27%
Recyclability 100%

repiroue

OKamura



The Perfect Combination of Sitting and Standing – a New Style of Work Posture

It is no secret that changing our posture throughout the day is essential to our wellbeing in the office. What's more, adapting a posture that is appropriate for the task at hand helps relieve stress placed upon the body. Okamura recommends five postures for increased office productivity and efficiency. Among them is the perching posture, a perfect combination of standing and sitting, which is suitable for a standing meeting or a touchdown. Our perching stool, *repiroae*, was brought to life with the intention of making the perching posture more accessible in the office environment.

Reducing stress on your body for a comfortable work posture

Perching posture does not apply extra pressure on the gluteal muscles and minimizes the stress placed on the intervertebral discs. Supporting the body from 3-points (both feet and the hip bone) stabilizes the pelvis. Furthermore, tilting the seat forward brings the pelvic angle close to that of standing position, meaning the S curve of the spine is almost the same as when standing, thus reducing pressure to the lower back. *repiroae* distributes body weight between the feet and the buttocks so that the legs are released from solely sustaining the weight.

PERCHING

【Ideal Posture】

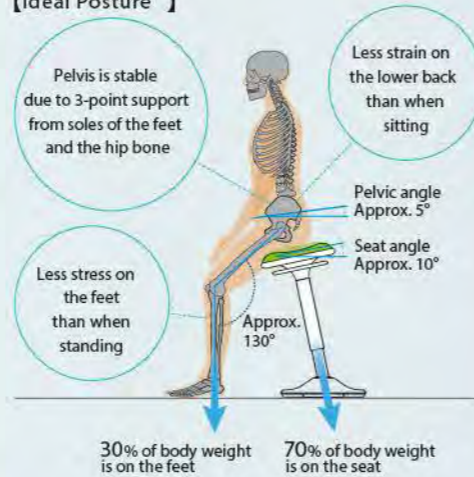

Source: joint research with Prof. Ko Matsudaira, M.D., Ph.D. Department of Medical Research and Management for Musculoskeletal Pain, 22nd Century Medical and Research Center, Faculty of Medicine, The University of Tokyo-Hospital, 2015



Adjust your posture to best suit

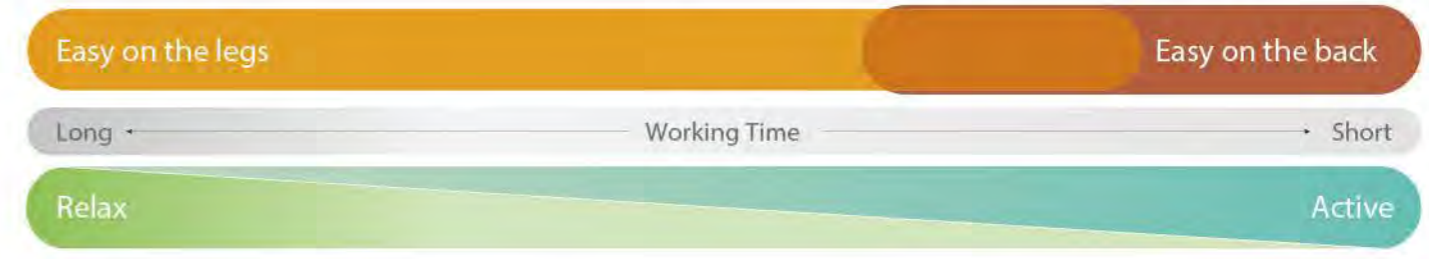
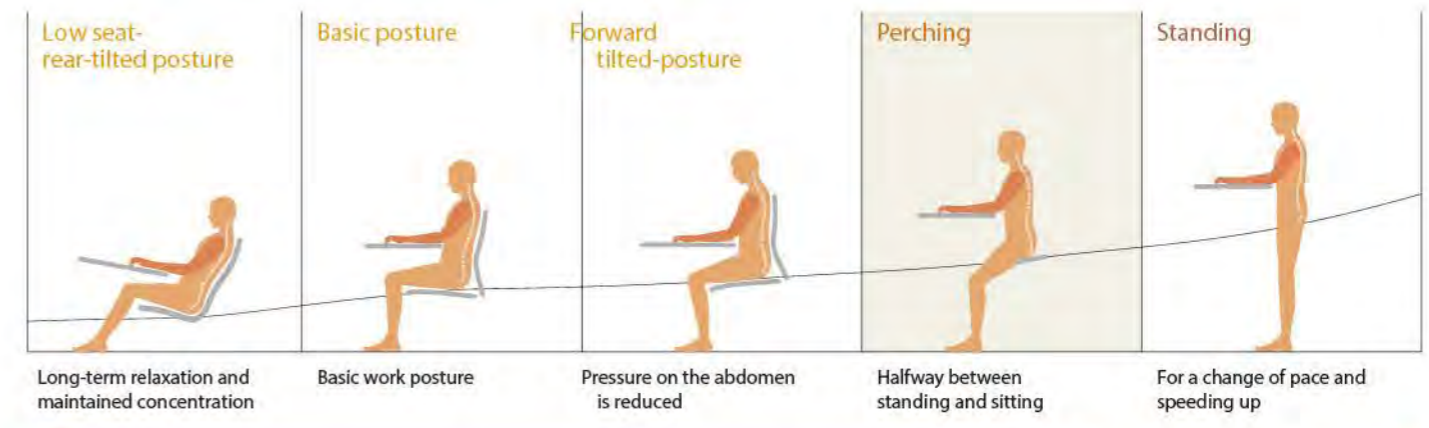

Introducing a new style of work posture

Until recent years, office workers had spent most of their time seated at their desks, but with increased recognition of height adjustable tables' benefits, more and more office workers are starting to work on their feet. Our perching stool, *repiroae* is the perfect companion to height adjustable tables, with its easy height adjustment function, it can accommodate office workers of all body types.

Specifications

Black shell
350φ × 565~815H
(13 7/8"φ × 22 1/4"~ 32 1/8")

White shell
350φ × 565~815H
(13 7/8"φ × 22 1/4"~ 32 1/8")

The supporting column can tilt in all directions with your body allowing you to sit at comfortable angle and move freely.

Use the lever underneath the chair to adjust the height between 565mm (22 1/4") to 815mm (32 1/8").

You can press the ring with all-around access underneath the seat, making height adjustment quick and easy.

[Colors]

Plain Knit						Interlock				
FSF2 White	FSF7 Beige	FSG3 Light Gray	FSF1 Black	FSF3 Medium Blue	FSG7 Sage	FXW2 Beige	FXW3 Dark Brown	FXW1 Gray	FXW4 Indigo	FXW9 Sage
FSG5 Dark Green	FSF5 Lime Green	FSG9 Yellow	FSG8 Orange	FSV7 Pale Pink	FSF9 Red	FXW5 Dark Green	FXW7 Yellow	FXW6 Terracotta	FXW8 Pale Pink	

● Specifications: Seat upholstery: Polyester Height adjustment lever: Fiberglass reinforced polyamide. Base: Polypropylene Seat shell: Fiberglass reinforced polypropylene

Legender

OKAMURA



www.copytel.com.mx

(624) 143-33-44
Los Cabos

(612) 125-23-35.
La Paz

(624) 191-35-56

[f /Grupo Copytel](#)
[/grupocopytel_bcs](#)



Legender

The Artistry of Leather Seating.

Legender is the ultimate executive chair. A combination of functionality, class and elegance drawing upon our expertise in ergonomics and our long tradition of creating beautiful furniture.

Soft and supple leather and world class design, for the worlds leading executives.





The fully upholstered leather executive chair is a timeless classic. Legender is a modern take on the concept complete with detailing options including design stitching and gradient perforation.





Functions



Smart Operation Mechanism

Designed to fit your body, and your style. Features include Smart Operation with height adjustment and reclining lock at your fingertips, responsive seat slide and tension controls.



Ankle-Tilt Reclining

An ankle-tilt mechanism enables anyone to find their most comfortable reclining position. Using the ankle as a pivot point, this mechanism moves in sync with the seat, for greater support—stimulating variation in posture and relaxation, with uninterrupted comfort.

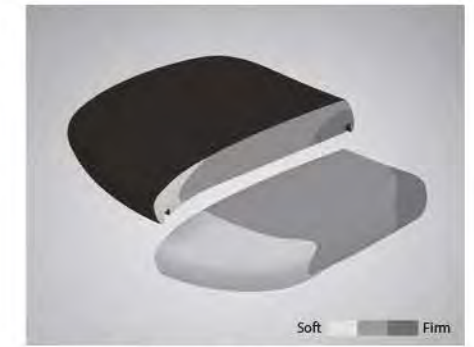

Multiple Density Cushion

Okamura's unique Multiple Density Cushion utilizes three types of urethane foam, of varying firmness layered together, to promote healthy sitting. The cushion provides softer support at the front of the seat, reducing pressure on the thighs for improved circulation. Denser cushioning at the back firmly supports the hips for stability and improved posture.



Seat Height and Depth Adjustment

Adjust the chair height, within a range of 17 3/8" (441mm) to 21 3/4" (551mm), using the lever in the right armrest. Adjustment of the seat depth, within a range of 2" (50mm), is available using the levers beneath the seat.



Reclining Tension Adjustment

Choose from four tension adjustment pre-sets for intuitive adjustment – all from a dial under the seat.

Ecology



PRODUCT CERTIFIED FOR LOW CHEMICAL EMISSIONS:
 UL.COM/GG
 UL 2818

Leather

Color Options



Design Options



Backrest Options



Base

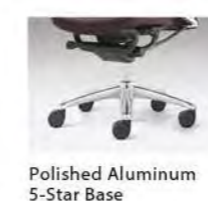

Polished Aluminum 5-Star Base

Arm Types



Closed Arm

Open Arm

Dimensions

*inch(mm)

Extra High back

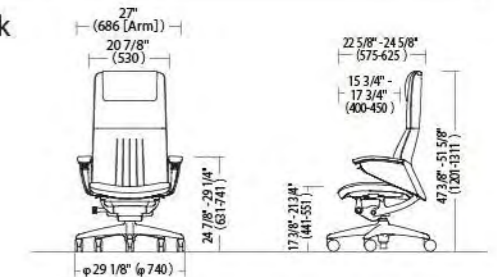

High back

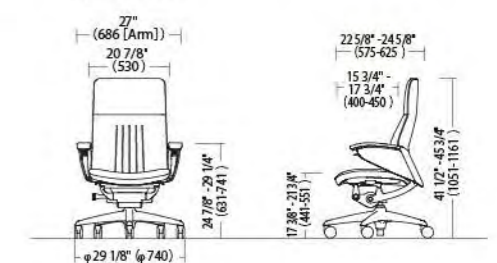

Legend

Leopard

OKAMURA





Rest your body to the comfort and feel of the human touch.



Leopard

To welcome, embrace and lift you

Okamura created the Leopard chair after a series of trials studying human movement to achieve the most comfortable chair. This involved the accumulated seating technology of Okamura and the robot technology of OKI being integrated for the first time. A new concept of "sit, relax, stand" reflects the series of movements required for the most natural position for maximum comfort and ease of use. The design welcomes your body, embraces gently and cradles you in comfort, then helps you rise and stand.

The body's natural supple movement is our model.

Ergonomic Comfort Seating ——— *Leopard*



The Leopard chair integrates the philosophy, technology and expertise that Okamura has been incorporating into office seating with OKI's 'Robot Leg' technology that applies the supple movement of human muscles and joints, creating a seat with the most natural posture that has ever existed.

'Smart Relaxation' is the secret of its comfort.

Without any adjustment
 it will embrace you as if
 it already knows the
 comfortability you prefer.

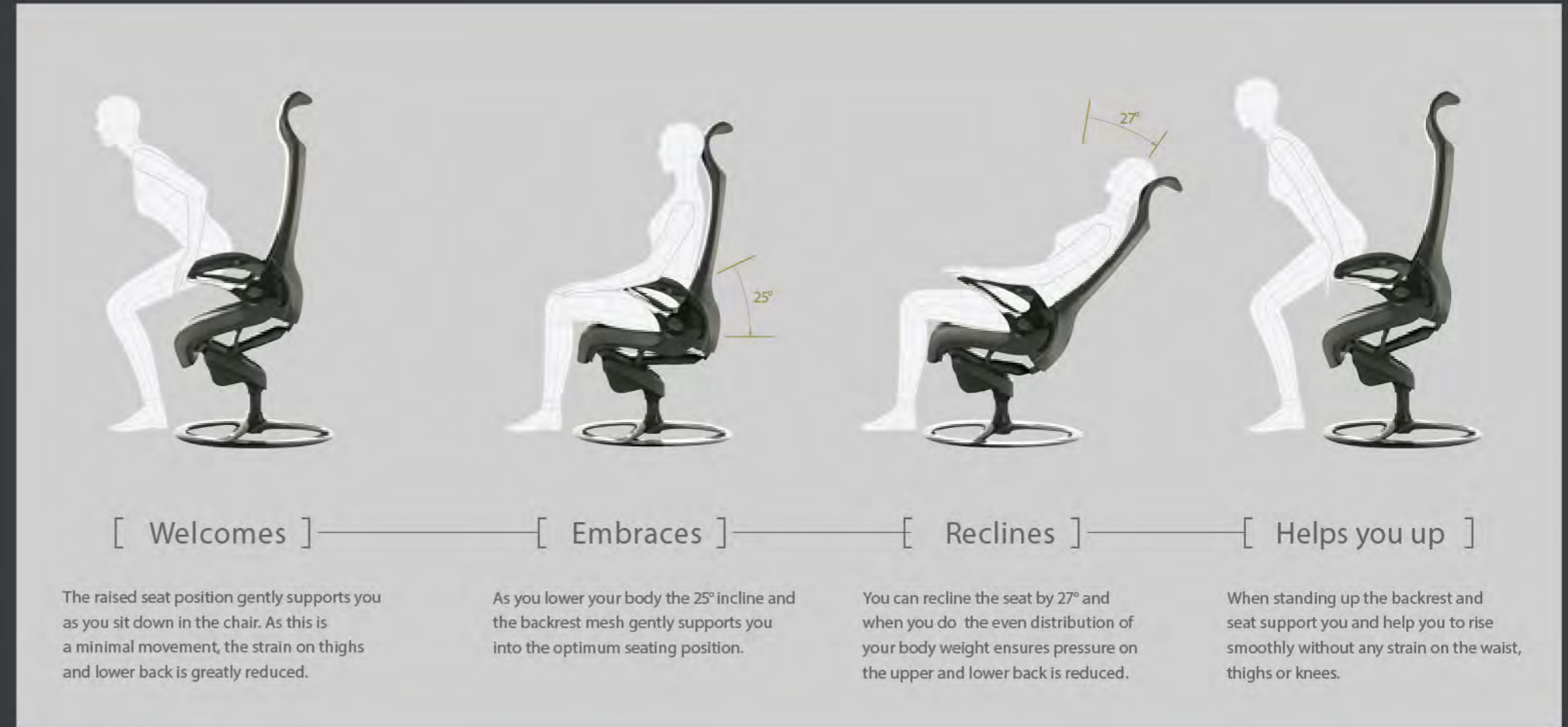
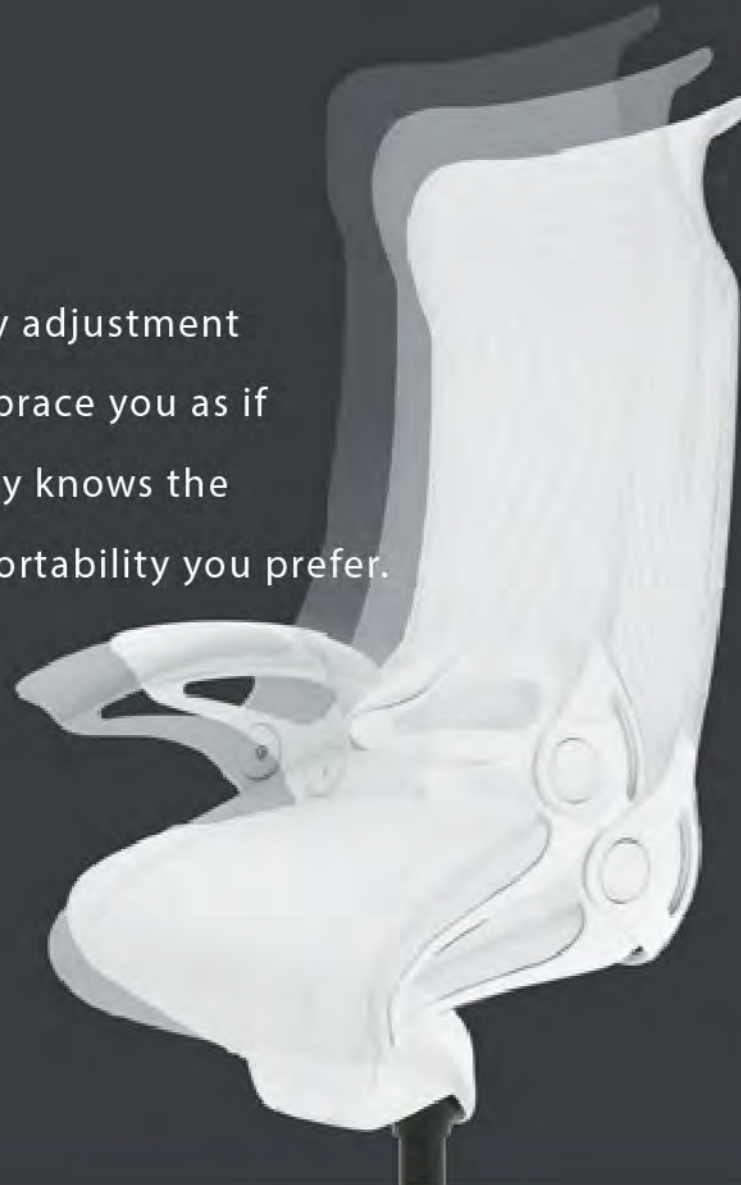

Analysis

Scientific data also verifies the gentle support given to the body.

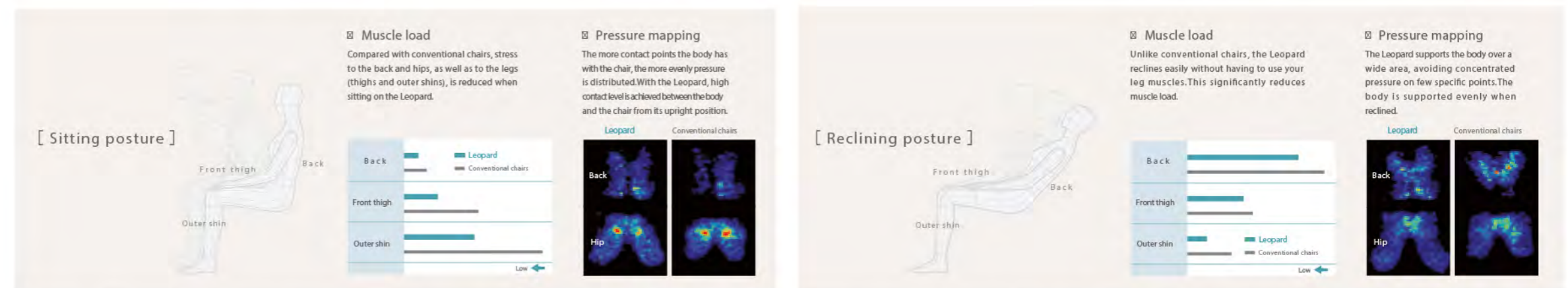

Verification Test on Muscle Load | Muscle load of a user seated in the Leopard was measured against the benchmark of natural standing posture for the amount of activity in the Erector spinae, Rectus femoris and Tibialis anterior muscles. Lower muscle activity indicates lower muscle load.



Hospitality that enriches your business.



1. Reception Room

Making your guests comfortable gives a clear impression of high quality hospitality.

In meeting rooms where your important guests are welcomed, comfortable seating adds a high level of congeniality to business discussions.

2. Open Space

Conversation is always enhanced when you are comfortable and relaxed.

Wherever people gather, whether for long or short periods comfortable seating is essential to maintain a relaxed and hospitable atmosphere.

3. Private Office

To think clearly you need to feel completely relaxed when you sit down.

When you sit down to rest or contemplate, a comfortable chair that gently embraces you gives you total peace of mind.

Award & Certification

Comfort



Ergonomics Excellence Award
 Ergonomics Excellence Award is certified by FIRA of The United Kingdom (Furniture Industry Research Association) based on English and EU standards. It is awarded only to products which meet the highest ergonomic standards - it is the most prized Ergonomic Award in Europe.



NeoCon Innovation Award
 Leopard received the Innovation Award for the notably innovative products which are selected beyond the boundaries of product categories at NeoCon World's Trade Fair in Chicago which is held annually.

Design



universal design award
 It is an International Award chosen for the best design product by Universal Design GmbH and iF International Forum Design GmbH in Germany.



iF awards
 This is a Global Design Award presented by iF International Forum Design GmbH, Hanover, Germany. It is awarded to the best design amongst Industrial products. The award criteria is design, materials, environmental acceptability, functions and safety of the product.



Good Design Award
 Good Design Award is selected based on comprehensive design marks and recommendation by Japan Institute of Design Promotion. The Award has been running over 50 years to find good design in life and developing industries. More than 35,000 products have received the award.



Safety



geprüfte Sicherheit
 The GS mark is the German safety standard. The GS mark is awarded to products which meet the standards of German PGSG and safety. GS is a trusted institution, all GS marked products are well proven in safety.

Ecology



GREENGUARD
 Greenguard is the internal air environment safety award developed by USEPA of The United States of America, SOW of Washington D.C. and Blue Angel from Germany for office furniture. The award standard also covers, roofing material, flooring, wall materials and carpet, interior furniture and equipment.



Color Variation

Black Frame [Seat : Leather]

Back										
Seat										
Code	FFS1	FFS2	FFS5	FFS7	FFS6	FFS3	FFS4	FFT2	FFT5	FFT7

Black Frame [Seat : Fabric]

Back							
Seat							
Code	FFR1	FFR2	FFR5	FFR7	FFR6	FFR3	FFR4

White Frame [Seat : Leather]

Back		
Seat		
Code	FFT2	FFT5



[High Back]
 Black Frame / Ring Base

Ring Base*

Frame Color	Black	White		
Reclining Tension **	Standard	Firm		
Seat Height	mm [inch]	435 [17 1/8"]	465 [18 1/4"]	495 [19 1/2"]

*The ring base features an automatic return mechanism.
 **The reclining tension of the "Firm" type is 30% greater than our "Standard" type.

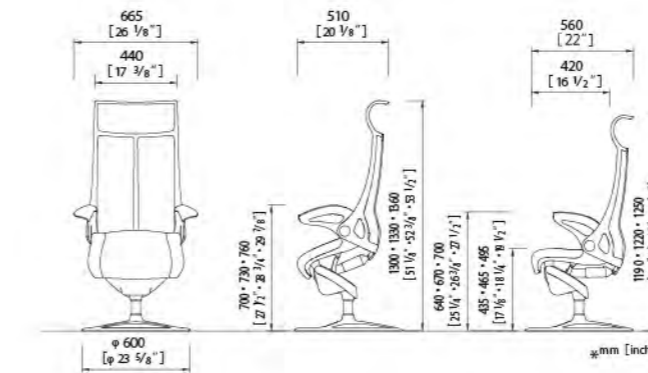

[High Back]
 White Frame / 5-Star Base

5-Star Base [with Glides]

Frame Color	Black	White		
Reclining Tension **	Standard	Firm		
Seat Height	mm [inch]	440 [17 3/8"]	470 [18 1/2"]	500 [19 5/8"]

**The reclining tension of the "Firm" type is 30% greater than our "Standard" type.

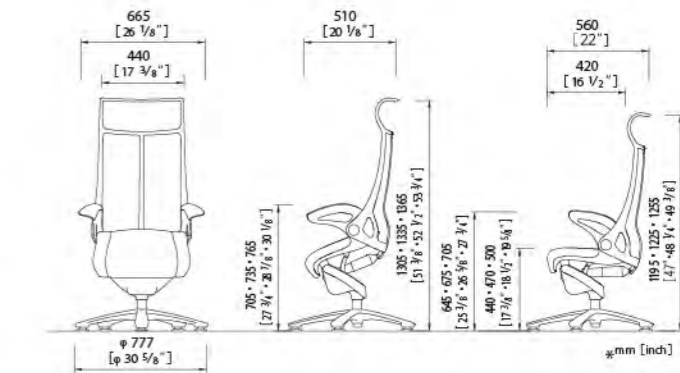

[Mid Back]
 White Frame / Ring Base

Ring Base*

Frame Color	Black	White		
Reclining Tension **	Standard	Firm		
Seat Height	mm [inch]	435 [17 1/8"]	465 [18 1/4"]	495 [19 1/2"]

*The ring base features an automatic return mechanism.
 **The reclining tension of the "Firm" type is 30% greater than our "Standard" type.

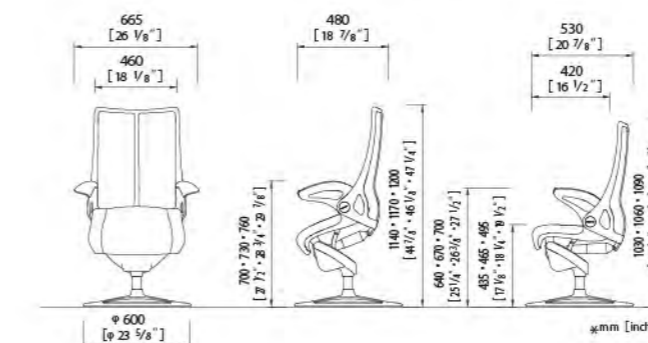

[Mid Back]
 Black Frame / 5-Star Base

5-Star Base [with Glides]

Frame Color	Black	White		
Reclining Tension **	Standard	Firm		
Seat Height	mm [inch]	440 [17 3/8"]	470 [18 1/2"]	500 [19 5/8"]

**The reclining tension of the "Firm" type is 30% greater than our "Standard" type.

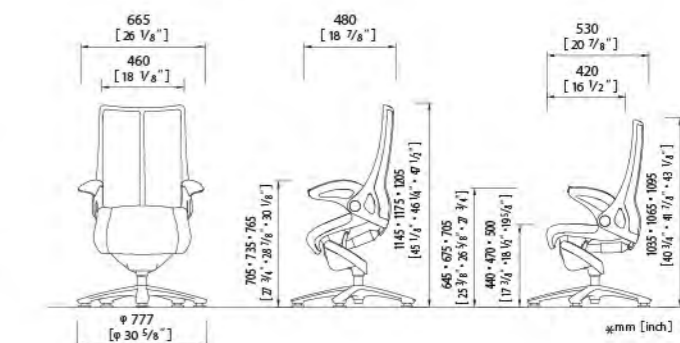

plimode

OFFICE SEATING

okamura





Beauty and comfort in equal measure.

Inspired by bespoke tailored suiting, Plimode is a rare weave of elegance and fitted comfort. The cloth on the back rest and seat has been painstakingly applied to ensure there are no gaps, divides, or creases.

Attention to every stitch, every detail, every fit, and every finish. With vast, yet refined fabric and color offerings, Plimode is made to fit its space.

The three-dimensional curve results in a soft contour that forms to your body—the product of years of research and expertise.

Plimode. A work of engineered office comfort 70 years in the making. Every bit of the craftsmanship and design that the house of Okamura has to offer.





Every detail, meticulously crafted.



Exquisitely curated fabrics and colors.



Splendid contours, tastefully curved.



Understated elegance.

A single, sweeping arc silhouettes the seatback tapering down into a fine, curved edge that unites it with the seat. The arm rests form supple, flowing curves. Seat adjustments have been simplified into a clean, minimal component. It's a design of pure beauty that is as pleasing visually as it is physically.

Slimmer.
Lighter.



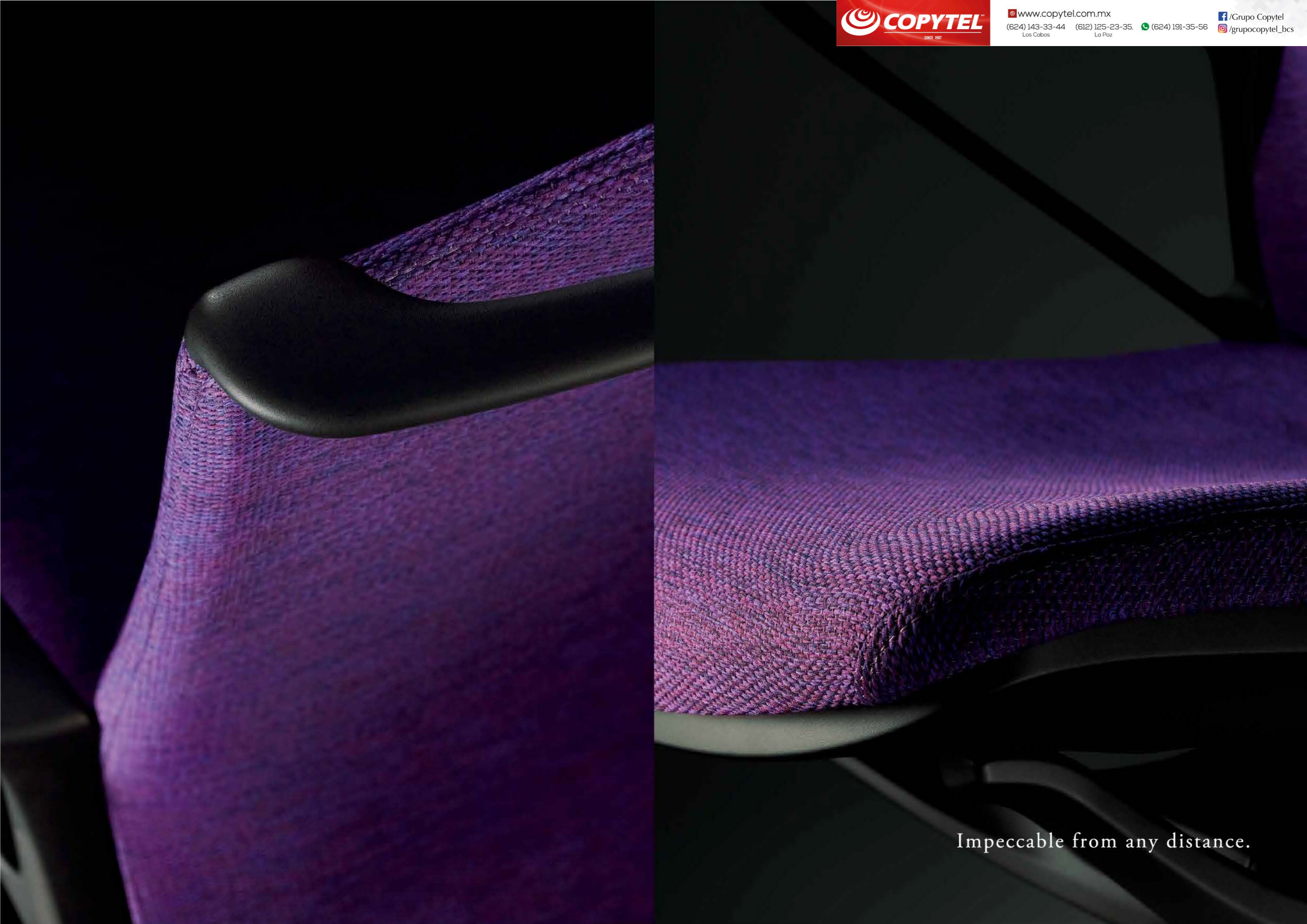

Impeccable from any distance.

Strong engineering, concealed within delicate aesthetics.

Every bit of technology at our disposal has gone into the design and comfort of Plimode. The inner mesh structure makes the back rest almost impossibly slim. Our advanced resin molding techniques have produced arm rests with a modern, streamlined curve. Under the seat, you'll find a compact control cluster. Engineering and ingenuity woven together in unprecedented quality.

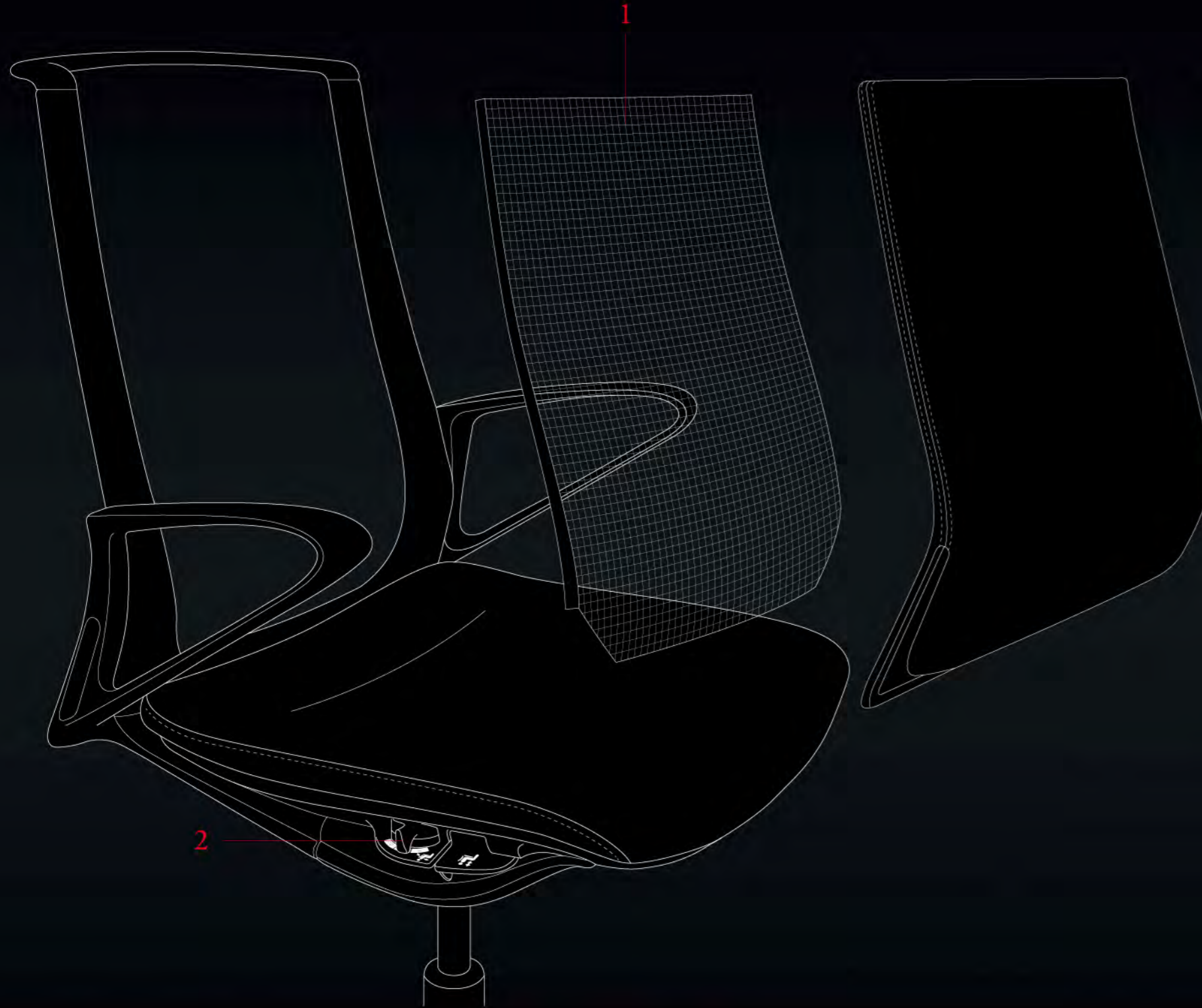

1 Inner Mesh Structure

The mesh structure provides a supportive cradling effect emanating a fitted comfort you don't normally experience in modern conference chairs.

2 Smart Slide Operation

The tension adjustment slider is easily accessible from a seated position. To control the seat tension or lock the recline, simply push the slider to your preference.



Styles to match any space.

Each workspace reflects a unique attitude; the furniture should too. We created Plimode with boundless style to work in synergy with its space. With 42 standard fabric colors and several other styling options including custom capabilities, there's a Plimode for every workspace.







Function



Seat Height Adjustment

Pull the lever under the seat to adjust seat height.
 (5-Star Base:110mm/
 Highstool:150mm)
 * 4-star base does not include this function.



Ankle Tilt Synchro-Recline

The back rest and seat move in tandem using your ankle as a natural pivot point. Reclined position offers support and comfort for upper thighs.
 (Recline Angle: Up to 15°)

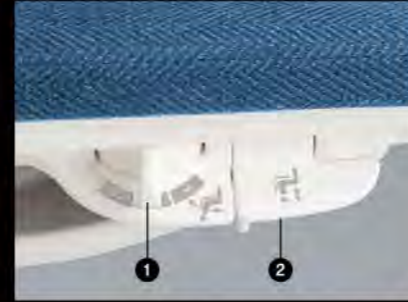

1. Tension Adjustment Slider 2. Seat Height Adjustment Lever

Seat adjustment controls are consolidated into a simple cluster under the seat. Controls are easily operated from a natural seated position. Simply slide the Smart Operation Lever to adjust recline tension (high/low) and to lock back rest position.
 * 4-star base does not include this function.



Handle

The handle makes it easy to pull up a chair.



Multiple Density Cushion

The urethane-molded seat offers three different levels of firmness. The seat transitions from soft padding in the front to firm support in the back.



Adjustable Arms

Press the button under the armrest to adjust the height in the range of 100mm.

Fabric

Upholstered

Herringbone



Hopsack



Plain



Interlock



Mesh

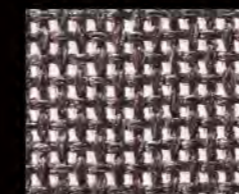

Plain



Interlock



Leather



Specifications

Backrest Types



Body Color



Frame Types



Seat Types



Arm Types

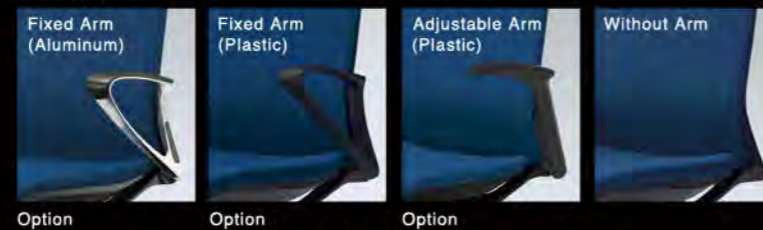

Base Types



* In addition to standard fabrics listed, there are more fabrics available from the "Okamura Premier Collection". Please visit our website for more information.

Dimensions *inch(mm)

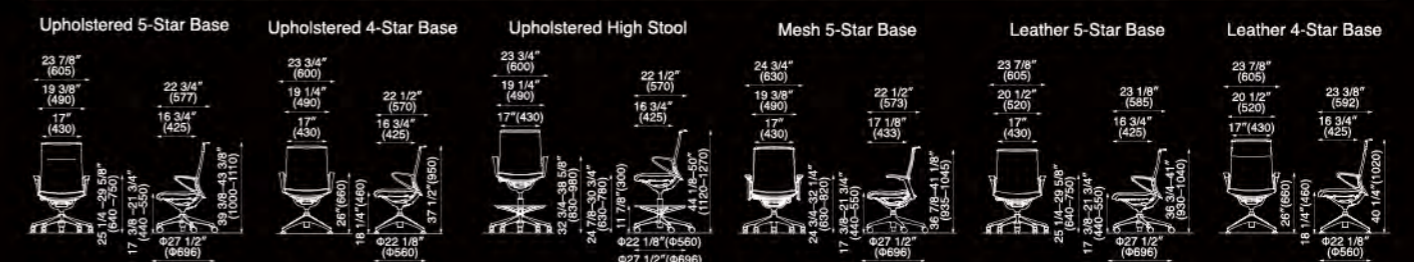

OKamura



www.copytel.com.mx
(624) 143-33-44 Los Cabos (612) 125-23-35 La Paz (624) 191-35-56
f /Grupo Copytel
i /grupocopytel_bcs

LIVES



Lives

The form of feeling good at work.

Today's office chairs demand more than functionality. Relaxed, residential-feel spaces create work environments where workers express themselves and thrive.

Lives Chairs bring a casual look to the office and are equipped with the state of the art features that employees have come to expect.



Lives

Work Chair

Cozy yet hardworking

Designed to fit in a café or in your living room, Work chair is equipped with essentials to keep a comfortable posture.



reeling good matters

Aesthetics and functionality work together.



Ergonomically Proven Comfort

With Okamura's original ankle-tilt reclining mechanism, the chair reclines back up to 15° and allows an upright work posture and a relaxed posture, accessible without any stress on the body.



Uninterrupted Control

All controls are placed under the right-hand side for intuitive and quick operation.



Color play

Two-toned fabric adds whimsical charm in the office space.



Today employees are untethered from their office desks. They are mobile and move from one place to another throughout the day. In open plan office spaces, The lounge chair makes a great touch-down spot while creating a personal oasis.



Lives

Work Lounge Chair

Laid-back capsule

The lounge chair is not only for relaxing. It is designed to keep the lower body relaxed while maintaining the spine and neck upright for an ideal posture for work.



Organic form

The back is engineered to embrace the user's body and support the ideal posture when working on a laptop.



Work veil creates greater focus

The veil creates a sense of being in a quiet space as the veil helps to block out visual and acoustic distractions.



Tablet

A surface large enough for a laptop that rotates 90°



Lives Work Chair



reddot award 2018 winner



Chair Types



Base Color Types



Color Options for Upholstery



Lives Work Lounge Chair



Chair Types

Arm Types



Base Types



Color Options for Upholstery



Muffle

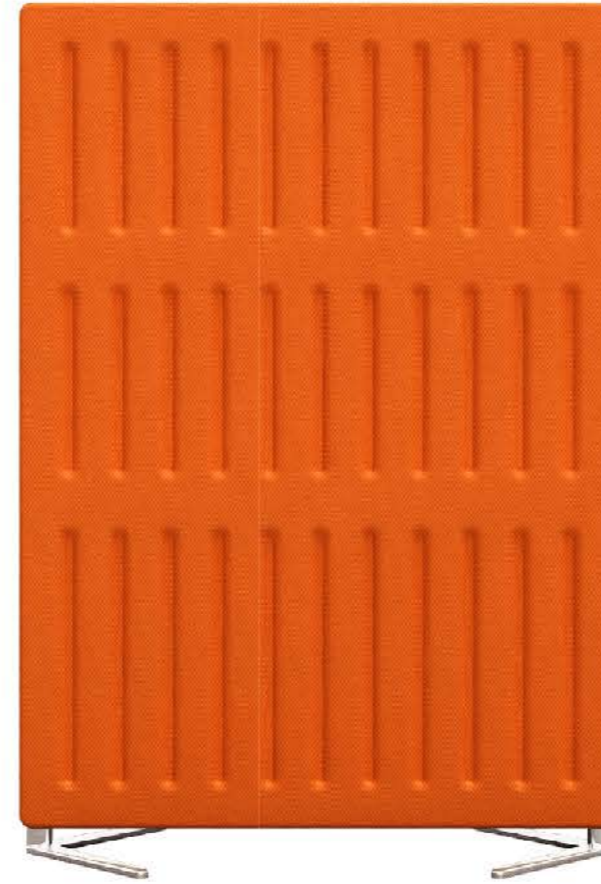

Opening up environments enhancing efficiency for single and team workers.



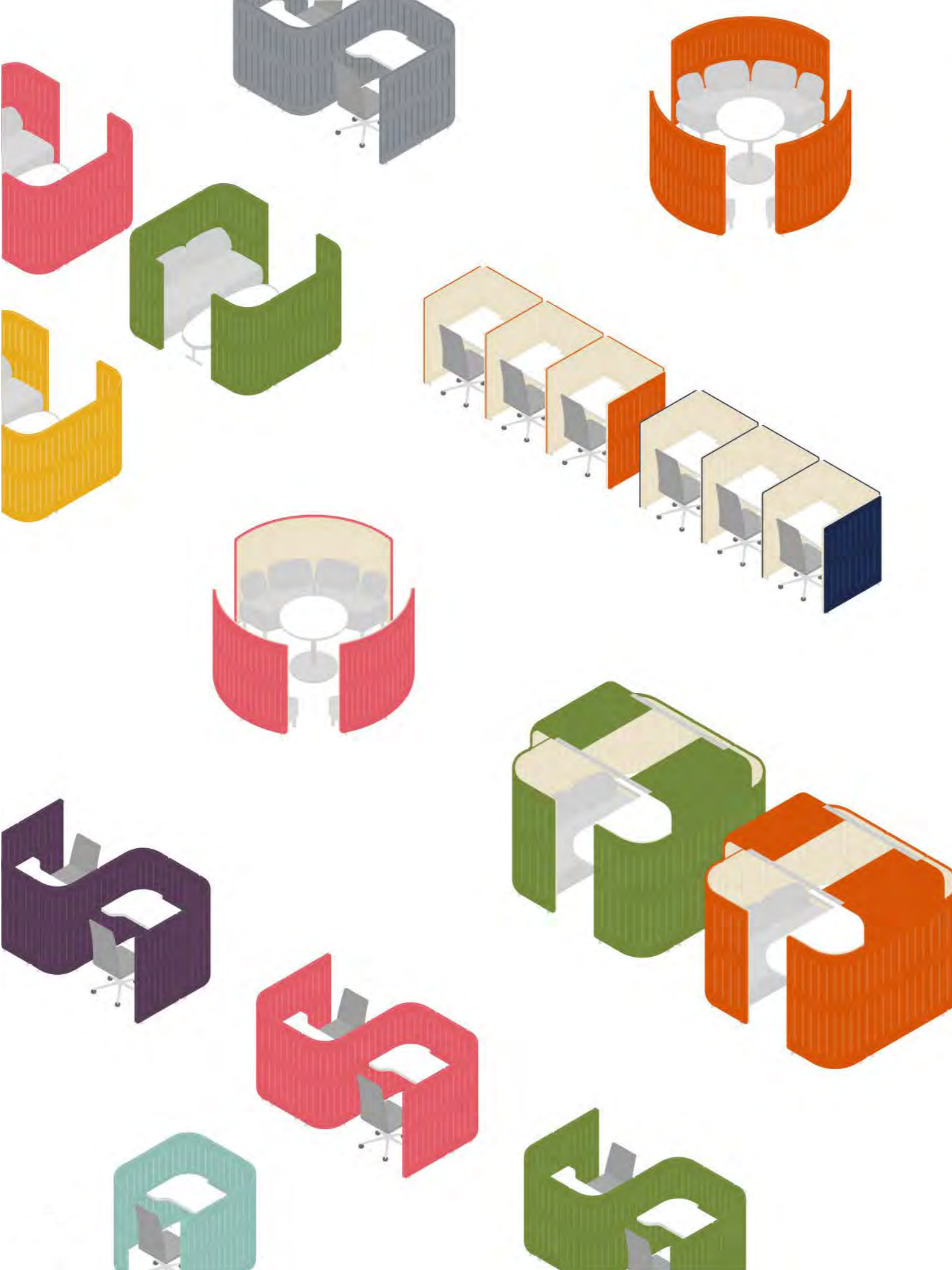

When workers' personalities and workstyle preferences are so diverse, why can't their environments be?

muffle creates concentration, promoting space that goes together in current open layouts.

Development of ICT equals that of office furniture. Now that we have fewer boundaries of when and where to work, more and more workers crave a workspace where they can fully concentrate without being interrupted by all these developed conveniences, and it is *muffle* that meets the very need. The streamlined contour that gently surrounds workers, R-shape that brings relaxed feel, fabric surface that offers a sense of security and warmth – these are the characteristics equipped with *muffle* for today's workers. *muffle* moderately shuts down the outer noise and eyes. This softens the nervousness and promotes concentration in a relaxed way. Color and layout variations are so diverse that it naturally responds perfectly to equally diverse workers. Workers can choose when and where to concentrate, still being included by the entirety. That is the concentration promoting space, *muffle*.

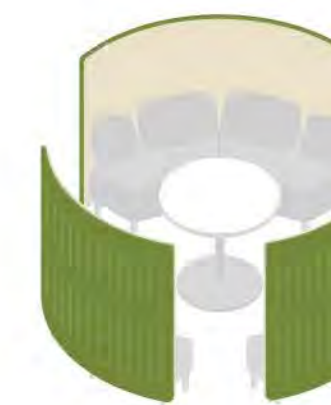

**Within all the office hubbub, you can quickly
shift into full concentration with *muffle*.**



For work that requires privacy and concentration

Soft, round walls create a comfortable and private work station.



This layout is formed by lining up multiple Booth Set M units in alternating opposite directions. The panels between neighboring seats provide complete shielding so that you can concentrate on your own work without concern for your neighbor's line of sight or movement.

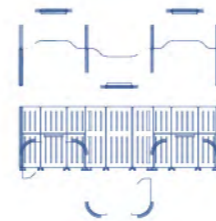

You can combine panels and a side-table with the one-person sofa to create a comfortable cockpit-like space for just one person. This provides a unique new style to concentrate your thoughts when thinking or devising a new plan.

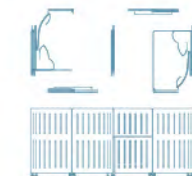

Our individual work stations with linked *muffle* units block lines of sight from the front and sides to increase the efficiency of short-duration intensive work.



A wide worktop is set in a comfortable space where you can work and concentrate completely on specific tasks or planning.





While each space is divided, *muffle* still connects the entirety of an organization with its round and soft walls. It's not for separation but for inclusion.

New ways to collaborate while staying focused

Broadening work style options, uniting team members.



Surrounded by panels for increased concentration, the enclosed meeting booth allows for private communication as well as mounted media support for up to a team of six.

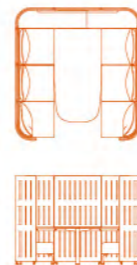

An AV board is added to this semicircular space using a curved shape representative of the *muffle* lineup to create an excellent meeting space. Meeting members can exchange thoughts while relaxing. Communication with people nearby is facilitated by the high counter set behind the *muffle* unit.

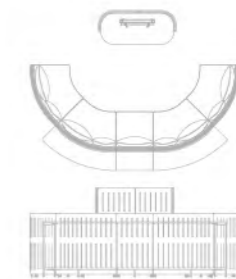

This combination of Meeting Set and a table creates an inviting space, with easy entry and exit, to enhance the feeling of togetherness during meetings.

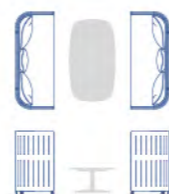

Enclosed almost completely, this setup serves as a distraction-free zone and brings you in close contact with others to get the job done.

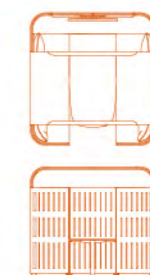

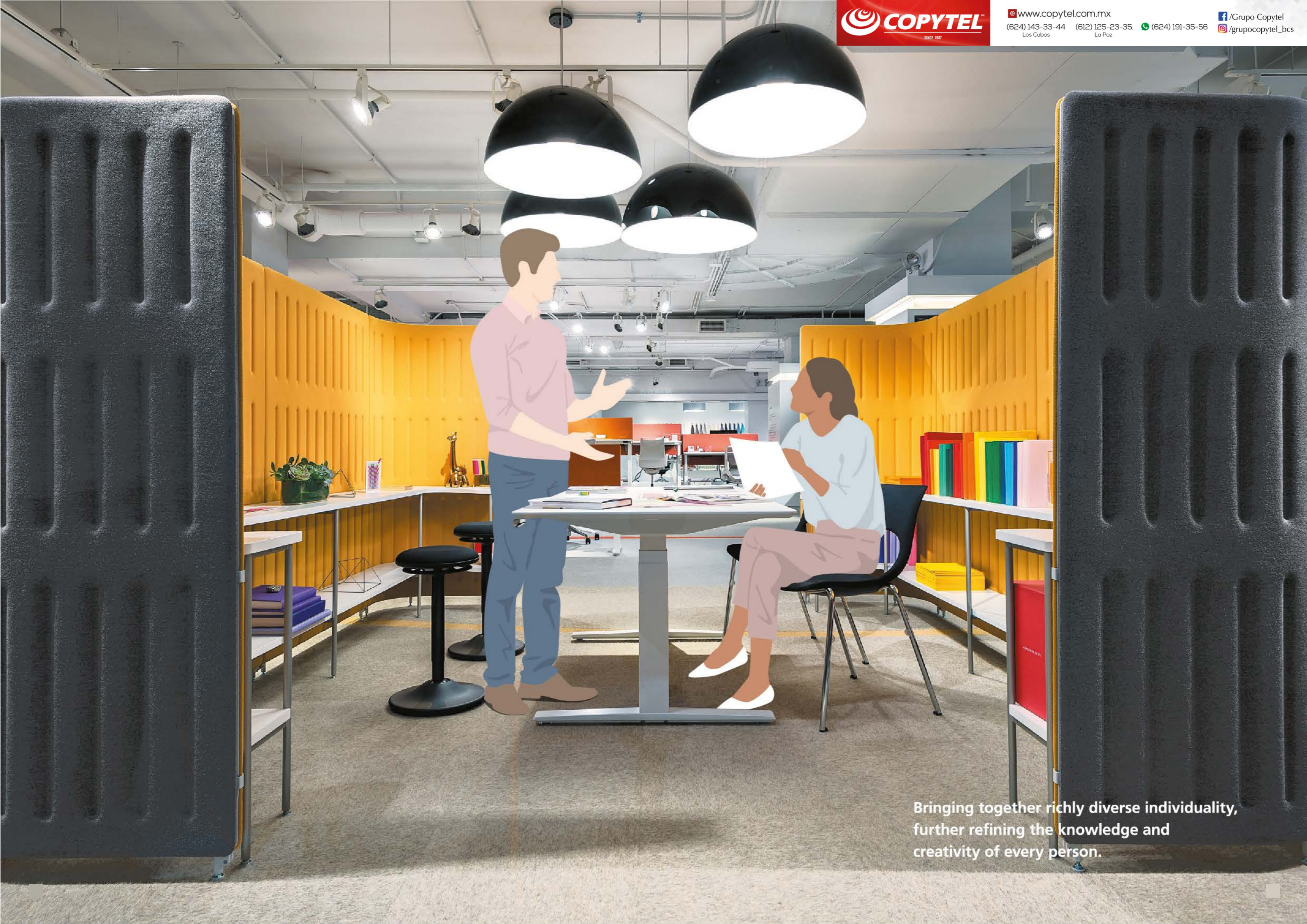

Bringing together richly diverse individuality,
further refining the knowledge and
creativity of every person.

Encouraging spontaneous collaboration

Multipurpose spaces that create interaction and fill offices with energy and conversation.



You can freely move the *muffle* panels to easily create a meeting space to match your needs. Combine with a height adjustable table, whiteboard, and other components to create a space perfect for brief standing meetings.

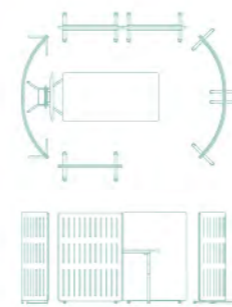

A simple room that can be used for careful consideration or as a temporary base for a project team. Shelves can be added to provide space for storage.

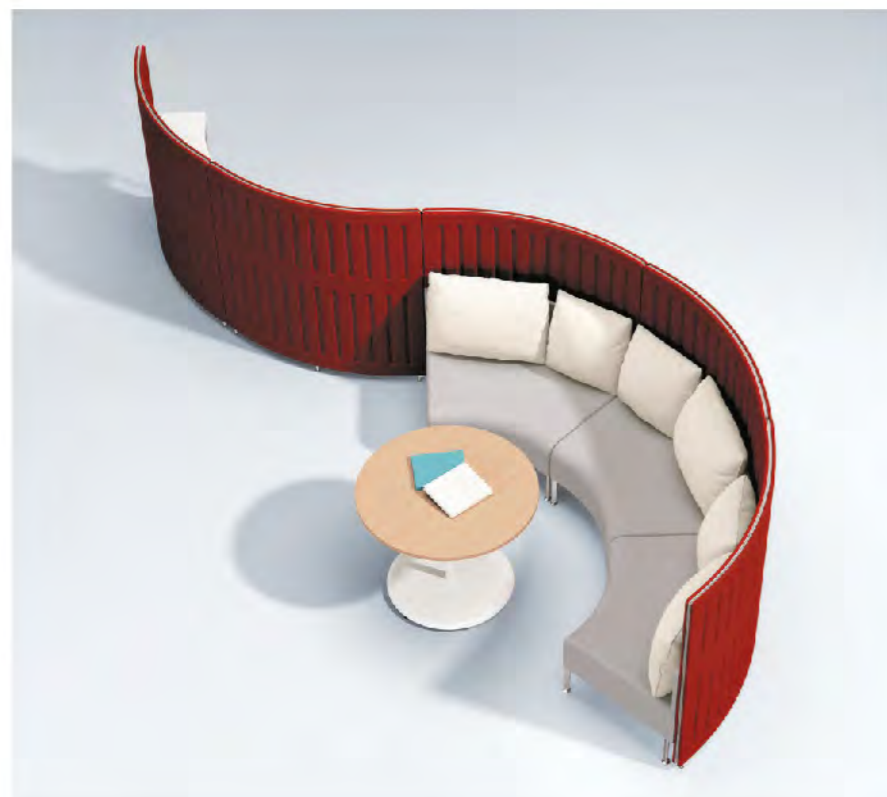
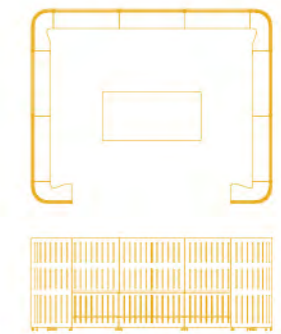

Comfortably surrounded by the tall curve-shaped panels, the sofa offers relaxation while providing an opportunity for communication with those passing by.

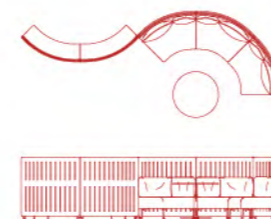

Shelves can be installed to the backside to provide a readily accessible location for documents and samples needed during meetings. This arrangement gives priority to functionality.

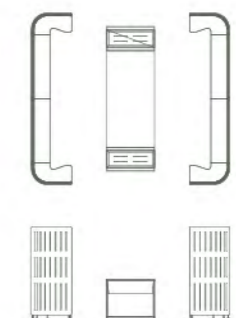

Accessories

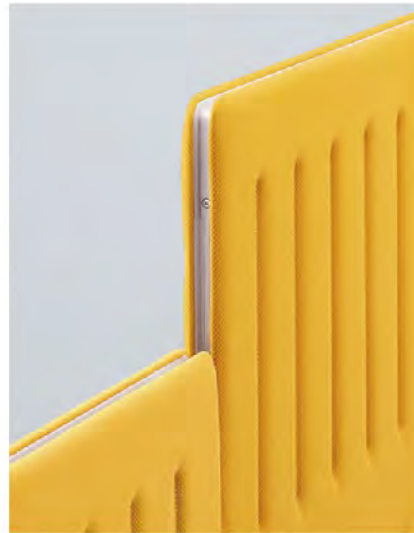

In-line change of height connection set



Straight connection set



Add-on acrylic screen Optional



Whiteboard Optional



Whiteboard mounting brackets Optional



Pinup board Optional Pale gray trim Black trim



Free-standing legs Optional

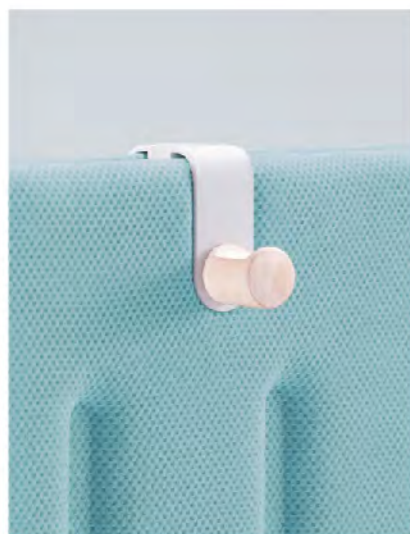

Hook Optional



Add-on acrylic screen: Side Optional

Power Source Diagram

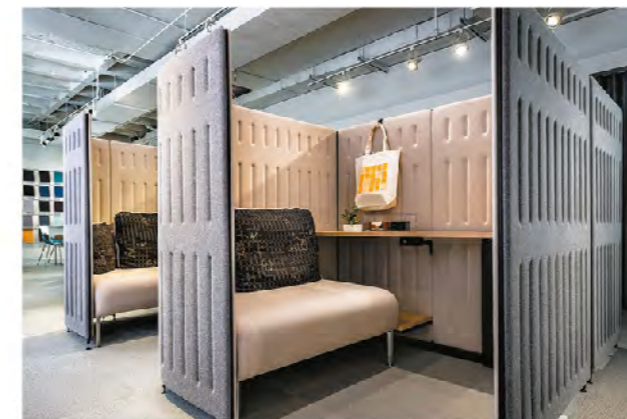
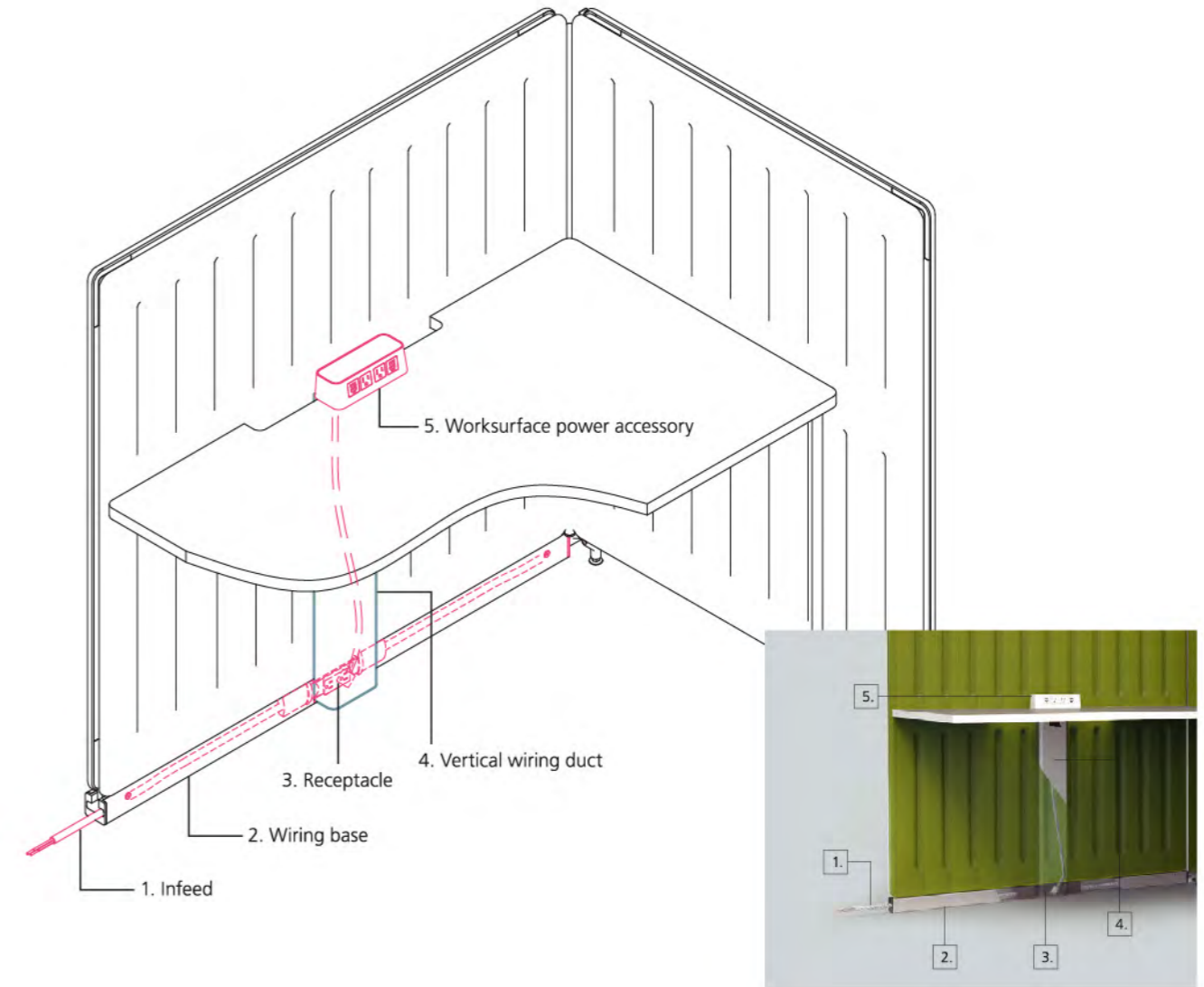

Craftsmanship

The Okamura craftsmanship lives in every detail of *muffle*

At Okamura, although everything is industrial, no products are delivered to clients without being checked by Okamura engineers' own eyes and hands for the final quality approval. We ask ourselves whether the grooved designs on the surface are fashionably uniformed if the R-shaped fabric corners are beautifully aligned, and if every single screw is firmly tightened. Only when all of these countless checks are finished, will *muffle* be delivered to clients as a complete product.

There are no compromises in all of Okamura's craftsmanship.

As it is our corporate tagline, "Quality pays for itself," and we strive to fulfill the highest quality for our users to enjoy. This spirit lives in every detail of *muffle*.

Experience *muffle* with your senses.



Dimple

F005 Peach	F017 Tomato *	F011 Raspberry *	F016 Marmalade *	F010 Pumpkin
F004 Mustard *	F027 Chamomile	F003 Pear *	F026 Oats	F006 Latte *
F009 Kiwi *	F015 Grape	F012 Coffee *	F020 Brown *	F018 Cocoa *
F024 Vanilla	F025 Mushroom	F001 Sesame *	F013 Blackberry	F002 Sage
F008 Plum *	F029 Indigo	F014 Blueberry *	F007 Huckleberry	F019 Charcoal gray *

*Special order color

Interlock

Beige Panel : FXT2 Seat : FXW2	Pale pink Panel : FXT8 Seat : FXW8	Yellow Panel : FXT7 Seat : FXW7	Terracotta Panel : FXT6 Seat : FXW6	Dark brown Panel : FXT3 Seat : FXW3
Gray Panel : FXT1 Seat : FXW1	Sage Panel : FXT9 Seat : FXW9	Dark green Panel : FXT5 Seat : FXW5	Indigo Panel : FXT4 Seat : FXW4	Dark gray Panel : FXT0 Seat : FXW0

Urethane leather

Beige Panel : PF11 Seat : PF21	Dark brown Panel : PF12 Seat : PF22	Black Panel : PF13 Seat : PF23

Trim

ZC11 Pale gray	Z25 Black

Worktop Laminates

MG99 White	MK37 Neo wood light	MK38 Neo wood medium	MK39 Neo wood dark
MX61 Prize wood light	MX62 Prize wood medium	MX63 Prize wood dark	

Leg colors

Z637 Skip silver	Z25 Black

Organic colors

Organic colors that directly communicate with your senses

The coloring theme for *muffle* uses natural and organic hues. The color palette is inspired by plants and fruits to generate gentle fusions between office spaces and human sensation.

Note: Photograph includes special order colors.

Risefit



Variations :

Tabletop shape



Bean

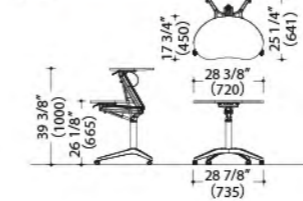

Oval

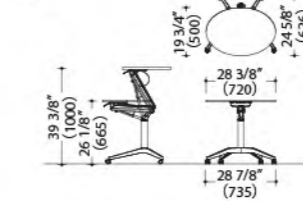

Rectangle

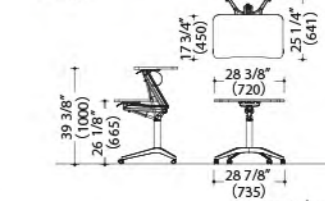

Functions :

The height adjustment range is from 26 1/8" to 39 3/8" (665 mm to 1,000 mm)



User-friendly lever for height adjustment



Column and Arm: Black
Base: Black



Column and Arm: White
Base: Polished Aluminum



Column and Arm: Black
Base: Polished Aluminum



Column and Arm: Silver Metallic
Base: Silver Metallic



Column and Arm: White
Base: White

Tabletop Color :



Prize Wood Light
MX61



Prize Wood Medium
MX62



Prize Wood Dark
MX63

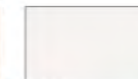

White
MG99



Neo-wood Light
MK37



Neo-wood Medium
MK38



Neo-wood Dark
MK39

Materials :

Tabletop surface: High pressure laminate
Arm: Die cast aluminum
Column: Steel
Base: Die cast aluminum

Leg frame colors :

White
Black
Silver Metallic
Polished Aluminum

Standards :

Meets or exceeds
BIFMA performance test.

Environmental aspects :

Recycled materials : 83%
Recyclability : 47%
Reducing VOCs to safeguard health
Cleared standard valves
based on the RoHS directive



INDOOR ADVANTAGE GOLD
FURNITURE

V conference table

Engineered simplicity.

OKAMURA





Elegant Tabletop

The table top is incredibly thin, less than 1" at its thickest point and tapering to a knife edge. With a span of up to 20 feet long, the top creates the effect of a floating plane, in a rectangle, boat or oval shape. The support structure is also remarkably minimal—yet structurally strong enough for the top to extend well past the legs.

■ Knife

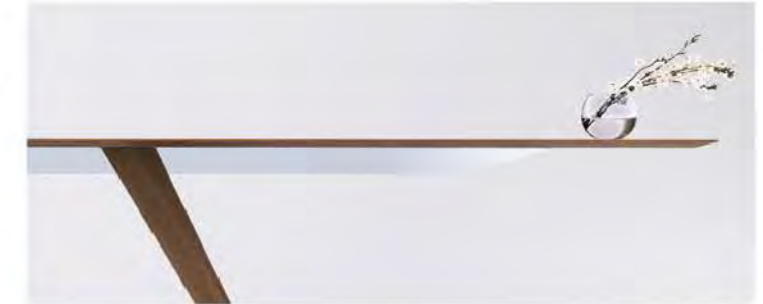

Exquisite Finishes

V conference table is offered in six beautiful, high quality finishes of wood veneers. Transitions between sections of the tabletop are seamless, creating a single, uninterrupted, beautiful span.

■ Wood veneer



WE51 | Dyed Oak WE52 | Dark Sapele WE53 | Walnut WE54 | Teak WE55 | Oak WE56 | Figured Maple

Integrated Technology

Integrated technology is concealed within each design, allowing for future flexibility. As technology tools advance toward wireless offices, V conference table locates power and data in its Tech Cradle—a small connective box discreetly tucked under the tabletop. Cables are hidden inside the legs, ensuring a polished look and more usable space.



Power charger / HDMI / VGA / AUDIO / USB / RJ11 / RJ45

The photograph is a North American specification.



The minimal silhouette of V conference table is achieved through a simple, canted leg design mirrored on either side of the table.



Shapes & Dimensions

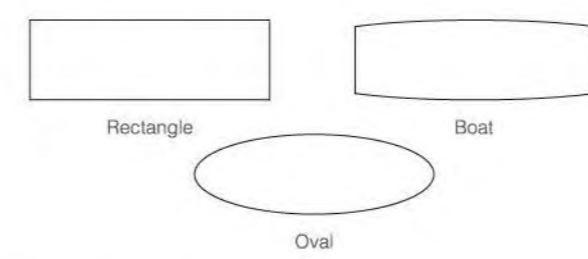

	W			
	2400	3600	4800	5600
D				
1200				
1500				

(mm)

Design Team

V conference table is designed by HOK Product Design®. Since 2009, HOK Product Design®, LLC has created innovative products for the built environment. Under the leadership of Senior Vice President and Director Susan Grossinger, the team partners with manufacturers to develop products that enhance their portfolios and strengthen their market presence.
hokproductdesign.com



Impossibly thin. Beautifully strong.

In today's workplace, conference rooms are challenged with shrinking size as well as the need to adapt to evolving technologies. V conference table is a collection of two conference tables defined by narrow contours that broaden office space, bringing people together beautifully.

V conference table was meticulously designed to create a profound presence. Despite its exquisitely simple design, the table places a premium on functionality through concealed technology and strong support.

Okamura's legacy of structural engineering, passion for creative materials, and signature craftsmanship unite in the V conference table—recreating the conference table through engineered simplicity.

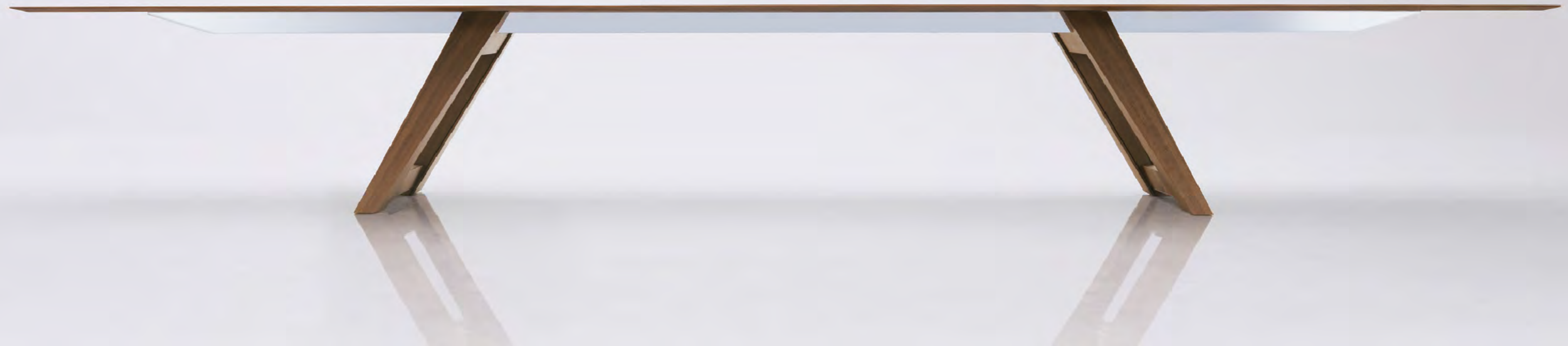

OKamura

www.okamuramexico.com

 @OkamuraMexico  okamura_mx